

**INELCO**<sup>®</sup>  
THE DISTINCTION

**modcon**<sup>®</sup>  
modular jacks

28 - 03 - 2017



INELCO the home of unparalleled quality and service in INterconnection and ELectronic COmponents is a European driven company, manufacturing European ideas, solutions and quality in Asia. INELCO's mission is to fulfill the requirements of their partners and customers and remains the best choice for cost-effective solutions. INELCO is the supplier of interconnection and electronic components and systems for networking, telecommunications and industrial applications. INELCO's product range includes modular (Western) plugs and jacks (modcon®), with and without integrated transformers (intrajack®), shielded and unshielded as well as terminals (voice services®), SFPs (compu-shield®), M12 (circon®), discrete components (discom® transformers, coils and inductors), USBs and other additional products and services.



## modcon® - modular jacks

### Technical Specification

Voltage Rating	125 VAC
Current Rating	1.5 A
Contact Resistance	30 mΩ max.
Insulation Resistance	1,000 MΩ min.
Withstanding Voltage	1,000 V AC 60 Hz 1 min.
Housing	High Temp. Polycarbonate or Polyester, UL 94 V-0/ UL 94 V-2
Shield	Copper Alloy Nickel Plated T = 0.25 mm
Contacts	Phosphor Bronze
Plating	Gold over Nickel
Selective Goldplating	3/ 6/ 15/ 30/ 50 μ"
Durability	500 ... 2,500 Mating Cycles min.
Storage Temperature	-40°C to +85°C
Operation Temperature	-40°C to +85°C

Mates with Modular Plug Conforming to ANSI/ TIA-1096-A

### Part Numbers

**J X C P (N N) Y Z - G**

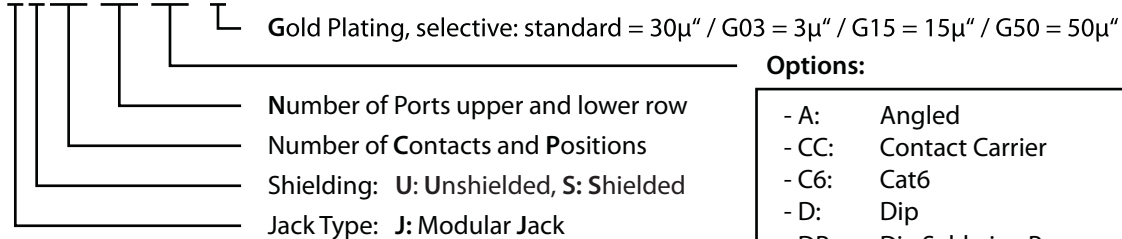

#### Options:

- A: Angled
- CC: Contact Carrier
- C6: Cat6
- D: Dip
- DP: Dip Soldering Peg
- EDGE: Card Edge
- E5: Cat5e
- FE: Ferrum
- H: Horizontal
- LL: With LEDs
- LP: Low Profile
- LU: Latch Up
- O: High Profile
- PF: Front Peg
- Q: Economy Version
- SB : Short Body
- SMT: Surface Mounted Technology
- SW: Switch
- T6: Enhanced Shield with EMI-Tabs
- V: Vertical (Top Entry)
- W: White
- Z: Press Fit

**Top Entry 8P PCB Jack UTP**

JU88V

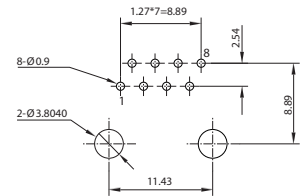
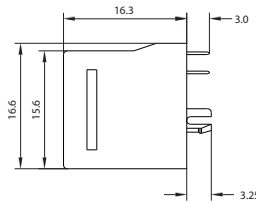
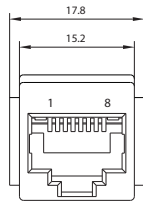

PC Board Layout  
Component Side Shown

**Top Entry 8P PCB Jack STP**

JS88VPF

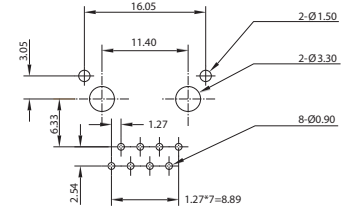
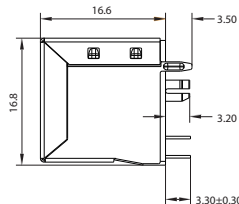
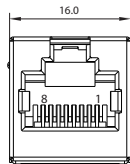
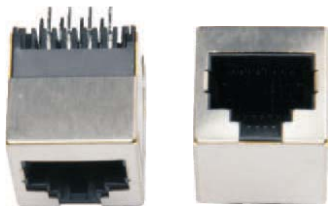

PC Board Layout  
Component Side Shown

**Top Entry PCB Jack STP**

JS88VT6PF

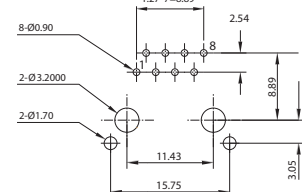
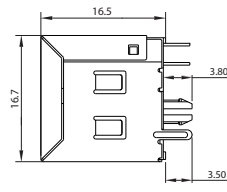
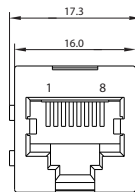
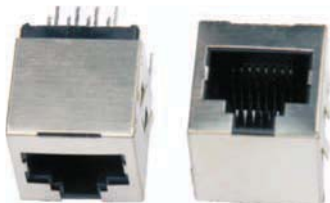

PC Board Layout  
Component Side Shown

### Top Entry 8P PCB Jack UTP

JU88VD

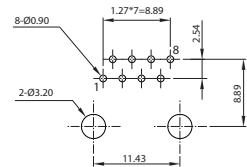
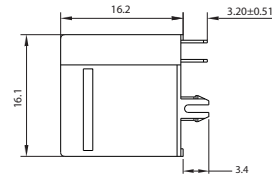
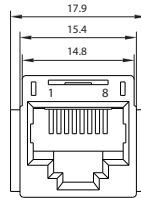

PC Board Layout  
Component Side Shown

### Top Entry 8P SMT Jack STP

JS88VDSMT

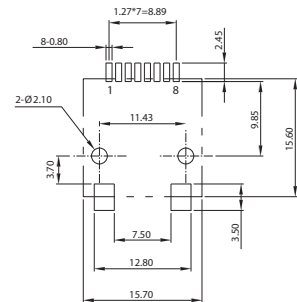
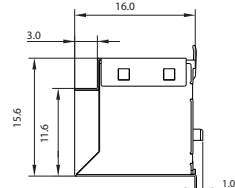
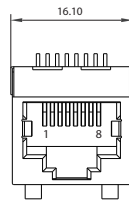
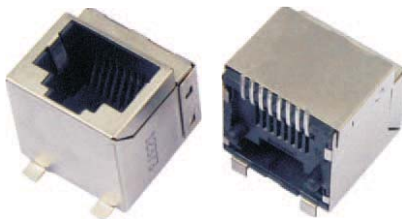

PC Board Layout  
Component Side Shown

### Top Entry 4P, 6P, 8P SMT Jack UTP

JUCPVSMT

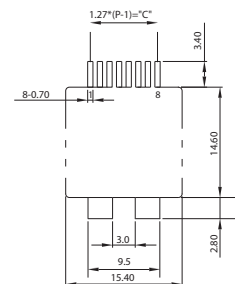
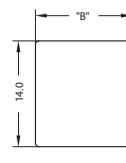
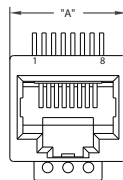
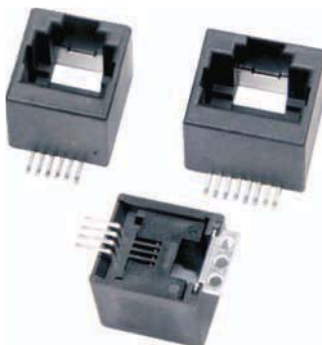

PC Board Layout  
Component Side Shown

Part Number	Type	DIM	"A±0.2"	"B±0.2"	"C"
JU44VSMT	4P		13.2	12.8	3.81
JU66VSMT	6P		13.2	12.8	6.35
JU88VSMT	8P		15.4	12.8	8.89

**Top Entry 8P SMT Jack UTP**

JU88VDSMT

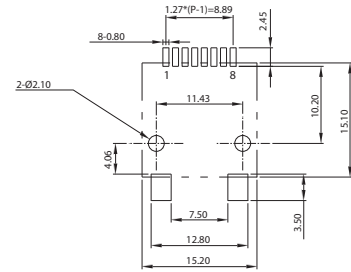
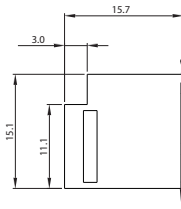
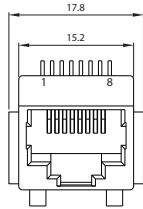

PC Board Layout  
Component Side Shown

**Top Entry 4P, 6P, 8P PCB Jack UTP**

JUCPVD

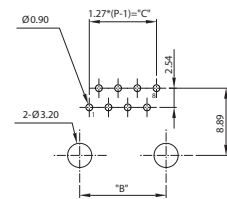
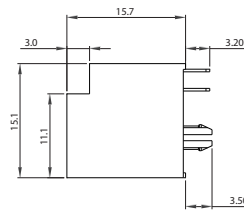
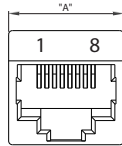
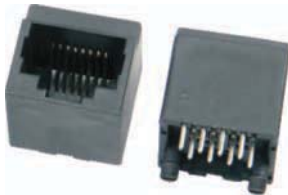

PC Board Layout  
Component Side Shown

Part Number	TYPE	DIM	"A±0.2"	"B±0.2"	"C"
JU44VD	4P		11.2	7.62	3.81
JU66VD	6P		13.2	10.16	6.35
JU88VD	8P		15.2	11.43	8.89

**Top Entry 8P SMT Jack STP**

JS88VSMT

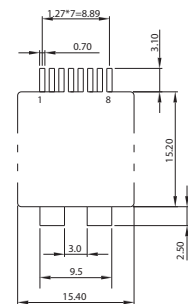
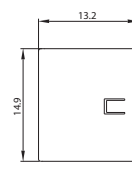
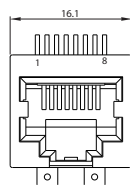
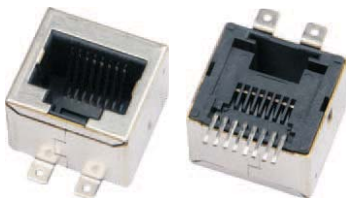

PC Board Layout  
Component Side Shown

### Top Entry 1\*N 8P PCB Jack UTP

JU880NV

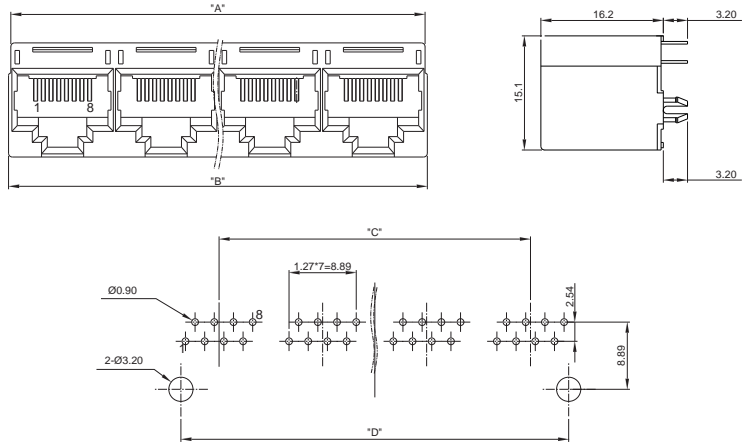
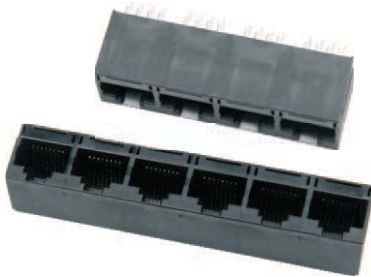

PC Board Layout  
Component Side Shown

Part Number	TYPE	DIM	"A±0.2"	"B±0.2"	"C"	"D"
JU8802V	1x2		27.4	28.0	13.70	23.80
JU8804V	1x4		54.8	55.4	41.10	51.20
JU8805V	1x5		68.5	69.1	54.80	64.90
JU8806V	1x6		82.2	82.8	68.50	78.60
JU8808V	1x8		109.6	102.2	95.90	106.00

### Top Entry 1\*N 8P PCB Jack STP

JS880NV

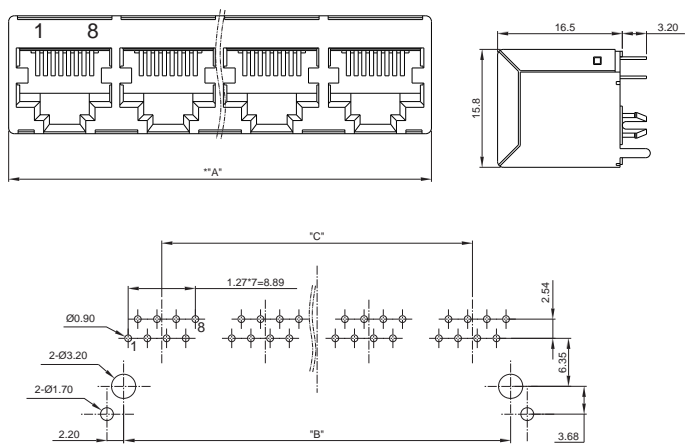

PC Board Layout  
Component Side Shown

Part Number	TYPE	DIM	"A±0.2"	"B±0.2"	"C"
JS8802V	1x2		28.6	23.8	13.70
JS8804V	1x4		56.0	51.2	41.10
JS8806V	1x6		83.4	78.6	68.50
JS8808V	1x8		110.8	106.0	95.90

**Top Entry L/P 8P PCB Jack STP 13.1 mm H**

JS88VLP

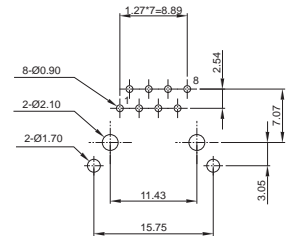
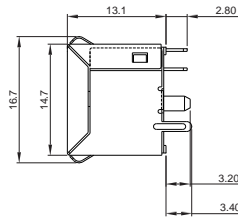
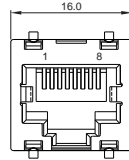
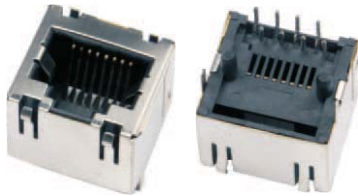

PC Board Layout  
Component Side Shown

**Top Entry L/P 8P SMT Jack UTP 12.7 mm H**

JU88VLPSMT

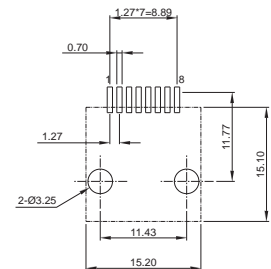
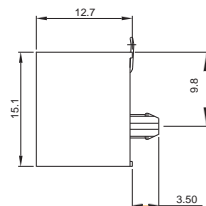
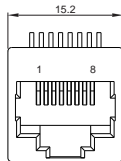

PC Board Layout  
Component Side Shown

**Top Entry L/P 8P PCB Jack DIP UTP 12.7 mm H**

JU88VLP

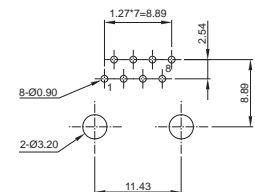
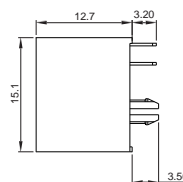
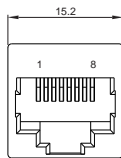

PC Board Layout  
Component Side Shown



### Top Entry 6P PCB Jack UTP

JUC6V

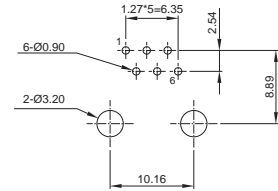
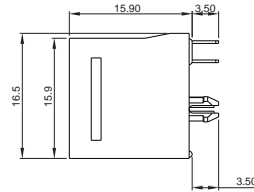
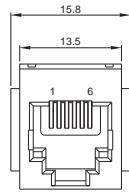
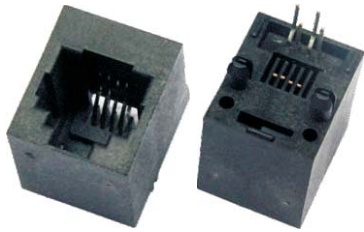

PC Board Layout  
Component Side Shown

### 45 P PCB Jack SP

JS88A

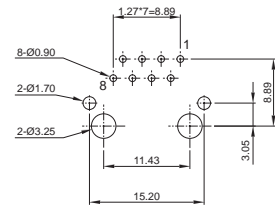
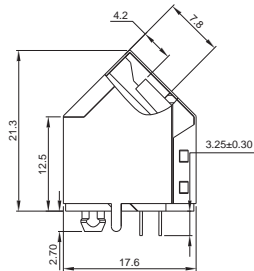
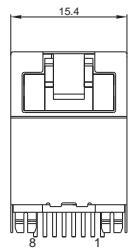

PC Board Layout  
Component Side Shown

### 45 P PCB Jack

JU88A

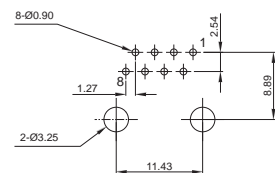
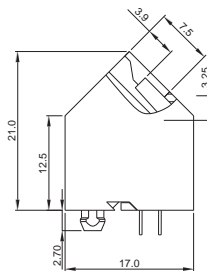
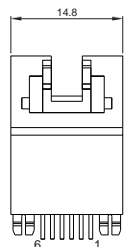

PC Board Layout  
Component Side Shown

**Side Entry L/P 6P, 8P PCB Jack UTP**

JUCPLP

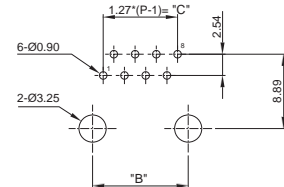
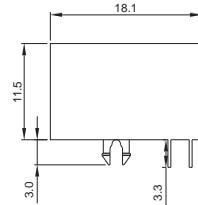
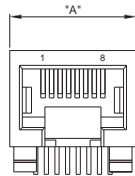

PC Board Layout  
Component Side Shown

Part Number	TYPE	DIM	"A±0.2"	"B±0.2"	"C"
JU66LP	6P		13.2	10.16	6.35
JU88LP	8P		15.1	11.43	8.89

**Side Entry 6P, 8P SMT Jack Card Edge STP**

JSCPEDGESMT

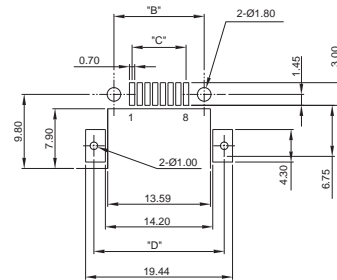
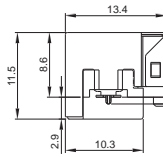
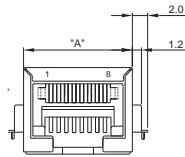
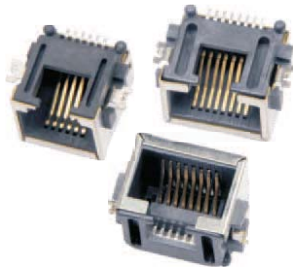

PC Board Layout  
Component Side Shown

Part Number	TYPE	DIM	"A±0.2"	"B±0.2"	"C"	"D"
JS66EDGESMT	6P		11.7	9.89	5.10	15.20
JS88EDGESMT	8P		14.4	11.94	7.14	17.24

**Side Entry L/P 1\*4 8P PCB Jack UTP**

JU8804LP

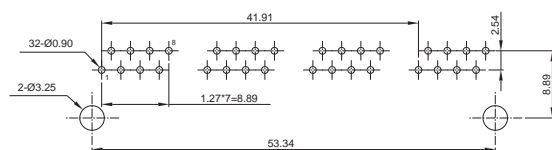
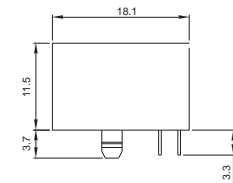
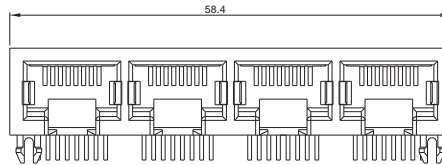
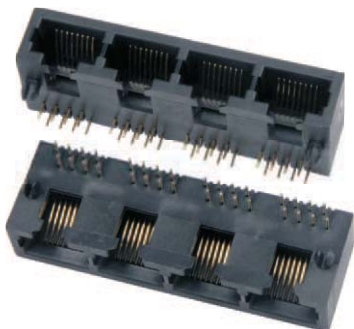

PC Board Layout  
Component Side Shown

### Side Entry 8P SMT Jack UTP

JU88ASMT

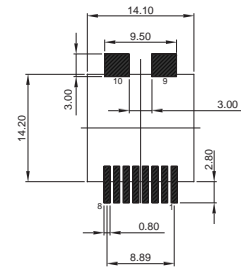
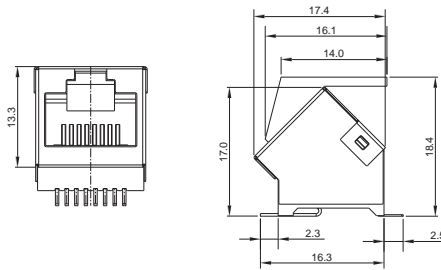
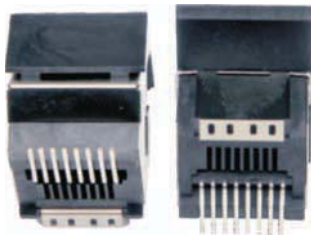

PC Board Layout  
Component Side Shown

### Side Entry 4P, 6P, 8P SMT Jack UTP

JUCPSMT3

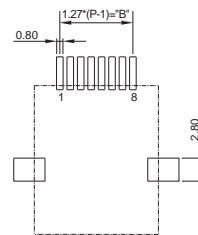
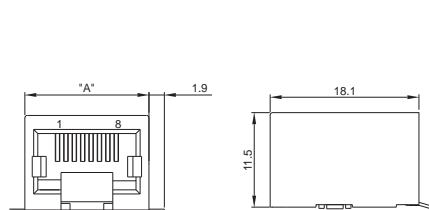

PC Board Layout  
Component Side Shown

Part Number	TYPE	DIM	"A±0.2"	"B±0.2"
JU44SMT3	4P		11.2	3.81
JU66SMT3	6P		13.2	6.35
JU88SMT3	8P		15.1	8.89

### Side Entry 8P Half PCB Jack UTP

JU88CC

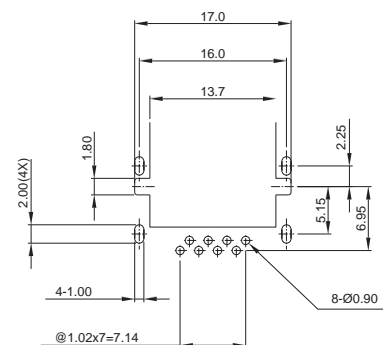
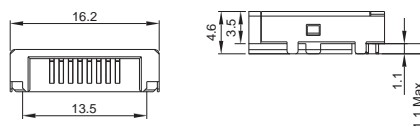

PC Board Layout  
Component Side Shown

Side Entry 1\*2 8P SMT Jack UTP

JU8802LUSMT

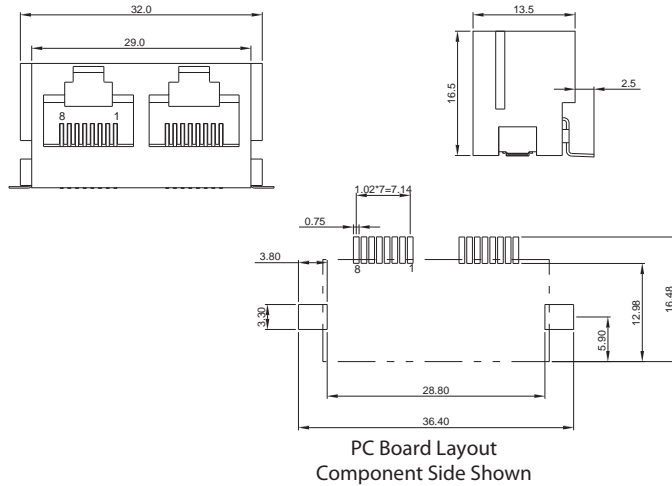

Side Entry 4P, 6P, 8P SMT Jack UTP

JUCPSMT1

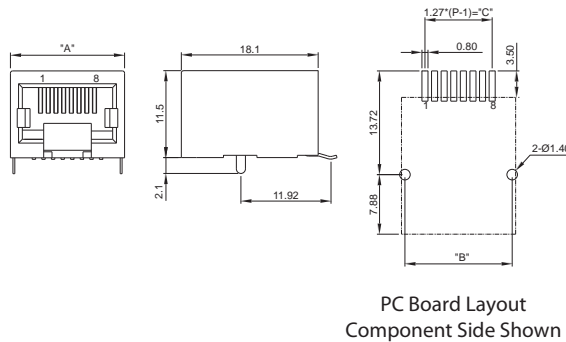

Part Number	TYPE	DIM	"A±0.2"	"B±0.2"	"C"
JU44SMT1	4P		11.2	10.16	3.81
JU66SMT1	6P		13.2	12.16	6.35
JU88SMT1	8P		15.1	14.19	8.89

### Side Entry 6P, 8P SMT Jack UTP

JUCPSMT2

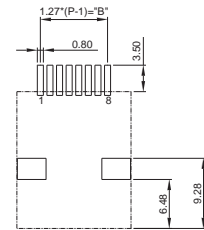
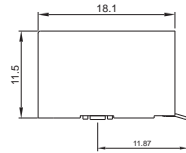
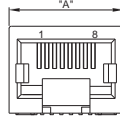

PC Board Layout  
Component Side Shown

Part Number	TYPE	DIM	"A±0.2"	"B±0.2"
JU66SMT2	6P		13.2	6.35
JU88SMT2	8P		15.1	8.89

### Side Entry 8P SMT Jack UTP

JU88DSMT

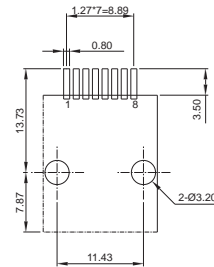
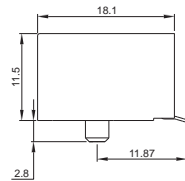
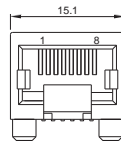

PC Board Layout  
Component Side Shown

### Side Entry 6P SMT Jack STP

JS66SMT3

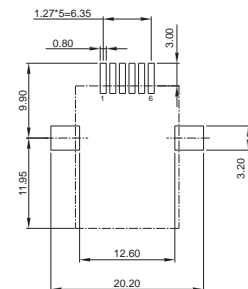
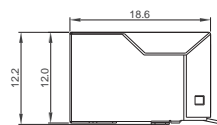
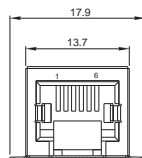
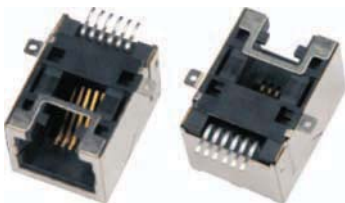

PC Board Layout  
Component Side Shown

**Side Entry 8P SMT Jack STP**

JS88SMT2

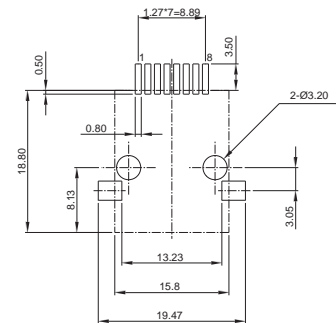
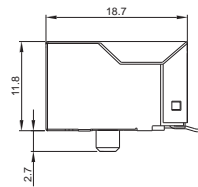
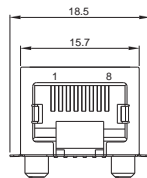
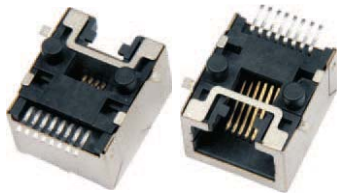

PC Board Layout  
Component Side Shown

**Side Entry 1\*4 Mini L/P 6P PCB Jack STP**

JS6604LUT6

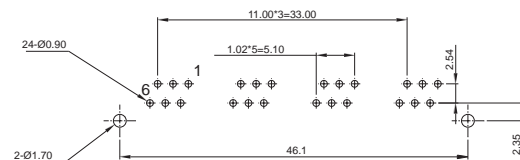
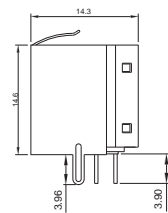
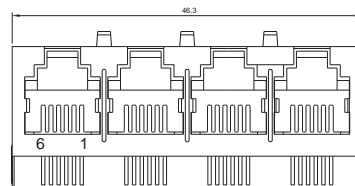
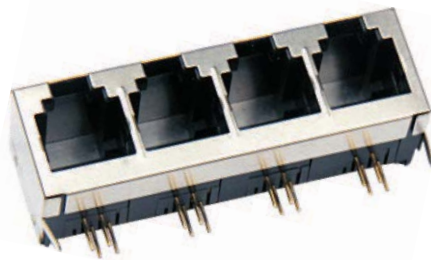

PC Board Layout  
Component Side Shown

### Side Entry 1\*N Mini L/P 8P PCB Jack UTP

JU880NLULP

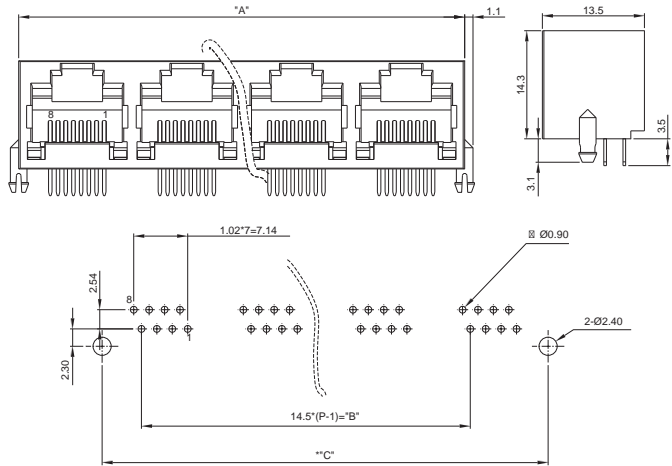
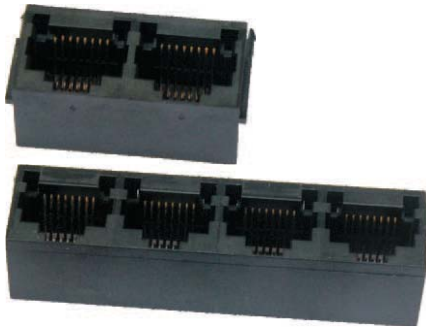

PC Board Layout  
Component Side Shown

Part Number	TYPE	DIM	"A±0.2"	"B±0.2"	"C"
JU8801LULP	1X1		15.5		15.50
JU8802LULP	1X2		30.0	14.50	30.00
JU8803LULP	1X3		44.5	29.00	45.50
JU8804LULP	1X4		59.0	43.50	59.00
JU8805LULP	1X5		73.5	58.00	73.50
JU8806LULP	1X6		88.0	72.50	88.00
JU8808LULP	1X8		117.0	101.50	117.00

### Side Entry 1\*1, 1\*4 Mini L/P 8P PCB Jack Metal Feet UTP

JU880NLULPW

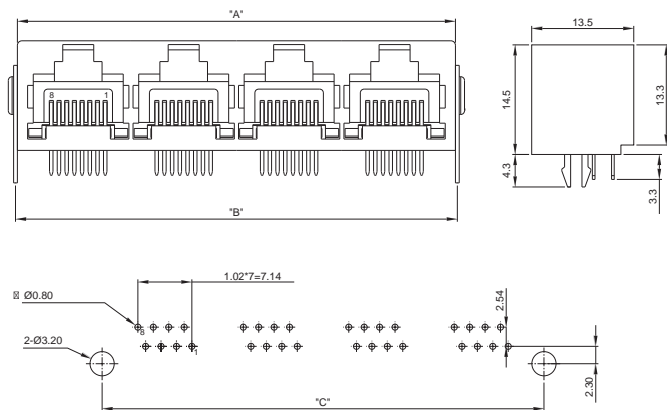
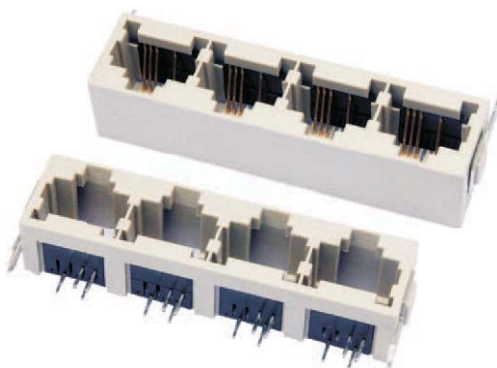

PC Board Layout  
Component Side Shown

Part Number	TYPE	DIM	"A±0.2"	"B±0.2"	"C"
JU8801LULPW	8P		16.1	16.60	16.60
JU8804LULPW	8P		58.0	58.45	58.45

**Side Entry 1\*N L/P 8P PCB Jack UTP**

JU800NLP

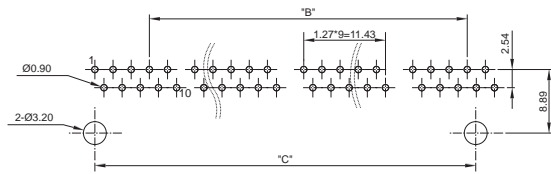
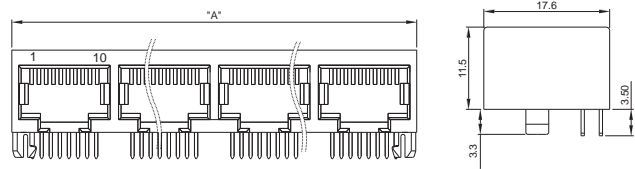
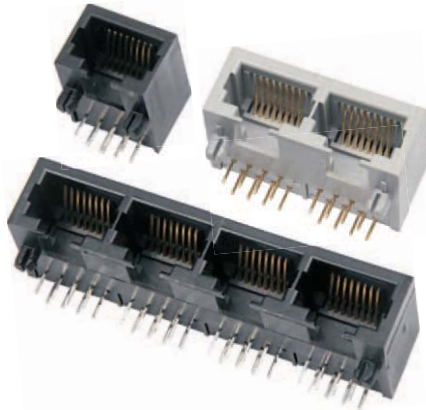

PC Board Layout  
Component Side Shown

Part Number	TYPE	DIM	"A±0.2"	"B±0.2"	"C"
JU8001LP	1X1		15.1		11.43
JU8002LP	1X2		30.4	13.97	25.40
JU8003LP	1X3		44.4	27.94	39.37
JU8004LP	1X4		58.4	41.91	53.34
JU8005LP	1X5		72.3	55.88	67.31
JU8006LP	1X6		86.3	69.85	81.28
JU8008LP	1X8		114.3	97.79	109.22

**Side Entry 1\*4, 1\*8 6P PCB Jack UTP**

JU660N

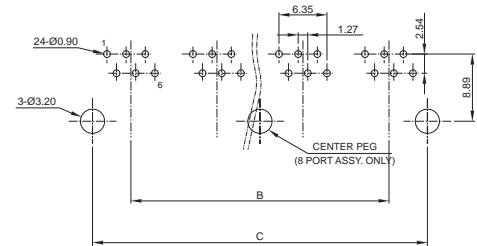
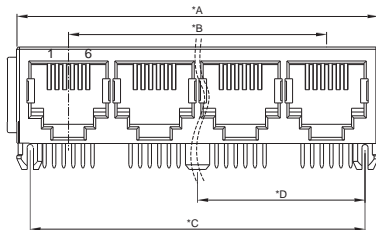
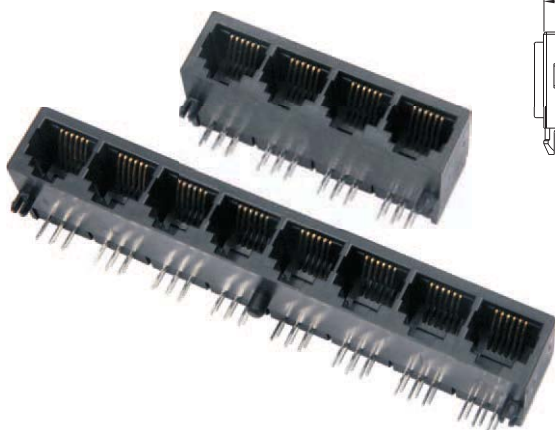

PC Board Layout  
Component Side Shown

Part Number	TYPE	DIM	"A±0.2"	"B±0.2"	"C"	"D"
JU6604	1X4		47.78	34.14	44.31	
JU6608	1X8		93.29	79.66	89.82	44.91



### Side Entry Mini L/P 8P PCB Jack STP

JS88LULP

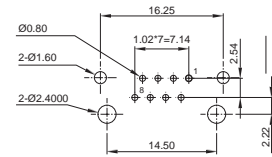
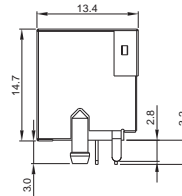
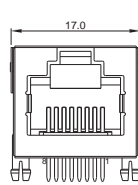

PC Board Layout  
Component Side Shown

### Side Entry L/P 10P PCB Jack STP

JS80LPPFT6

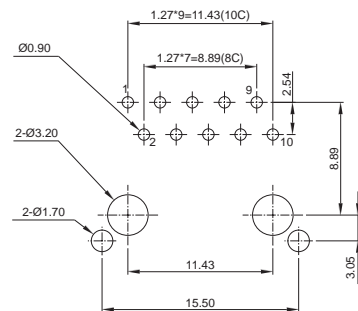
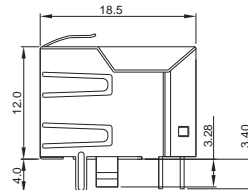
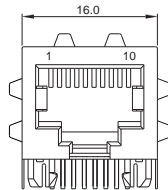

PC Board Layout  
Component Side Shown

### Side Entry L/P 10P PCB Jack STP

JS80LPT6

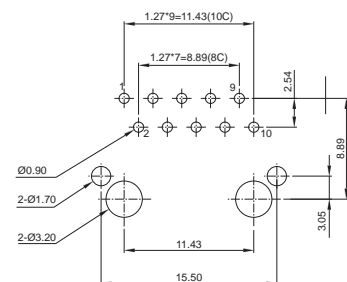
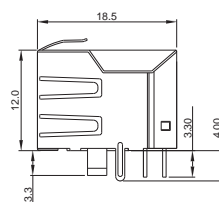
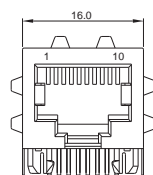
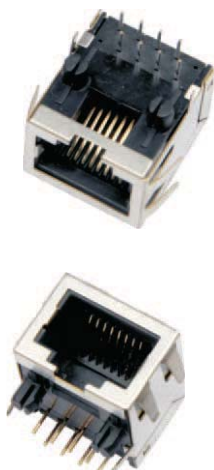

PC Board Layout  
Component Side Shown

**Side Entry 10P PCB Jack UTP**

JU80SB

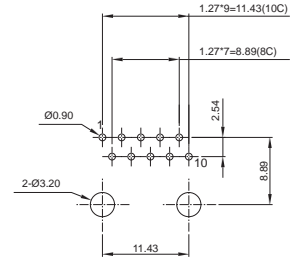
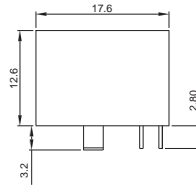
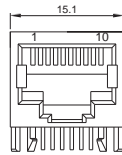

PC Board Layout  
Component Side Shown

**Side Entry 10P PCB Jack STP**

JS80SB

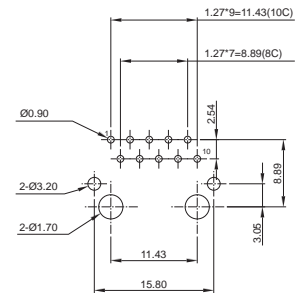
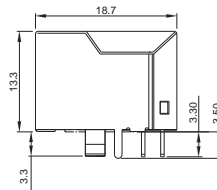
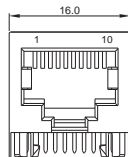
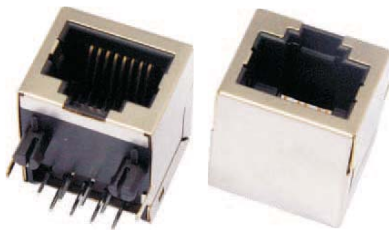

PC Board Layout  
Component Side Shown

**Side Entry 10P PCB Jack STP**

JS80SBPF

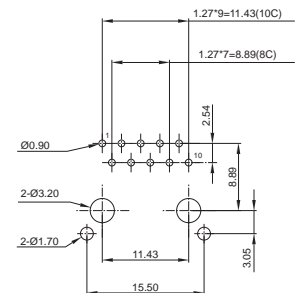
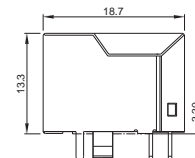
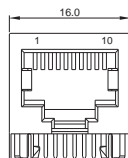
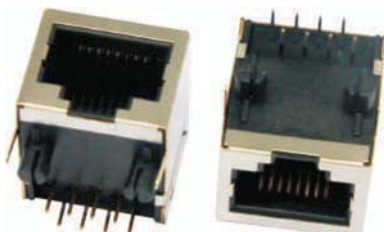

PC Board Layout  
Component Side Shown

### Side Entry 1\*1, 1\*4 8P PCB Jack UTP

JU880NFE

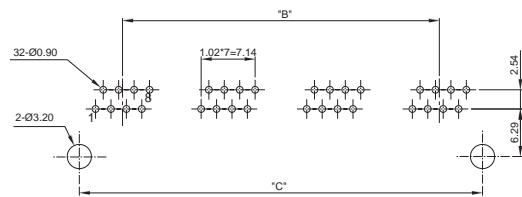
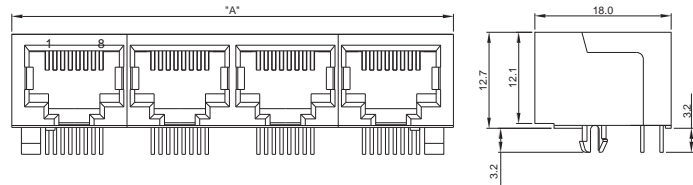
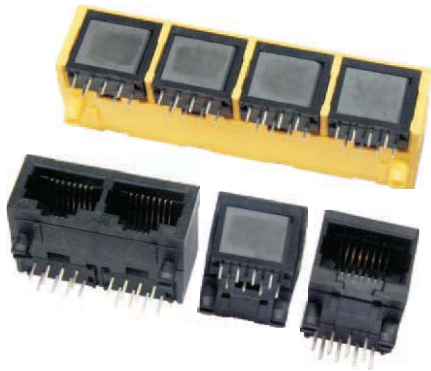

PC Board Layout  
Component Side Shown

Part Number	TYPE	DIM	"A±0.2"	"B±0.2"	"C"
JU8801FE	1X1		14.1		11.43
JU8804FE	1X4		58.4	41.91	53.34

### Side Entry 1\*4 6P PCB Jack UTP

JU6604FE

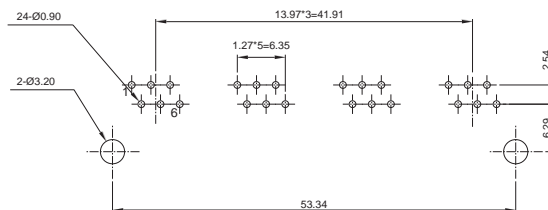
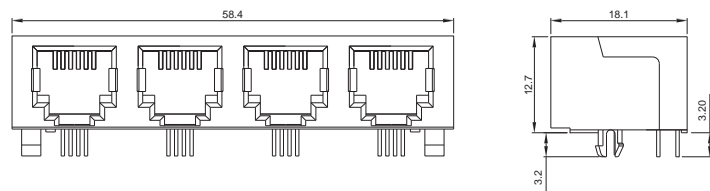
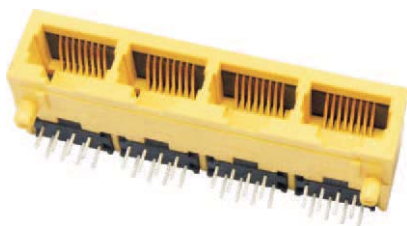

PC Board Layout  
Component Side Shown

**Side Entry L/P 8P PCB Jack STP**

JS88LPPF

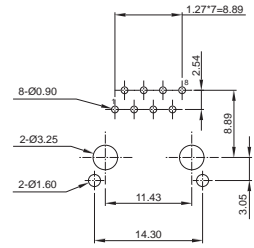
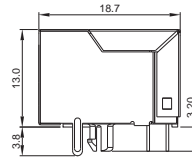
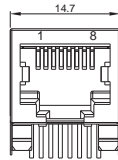
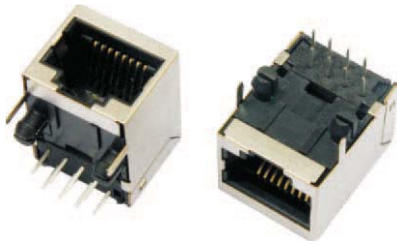

PC Board Layout  
Component Side Shown

**Side Entry 4P, 6P, 8P PCB Jack UTP**

JUCPO

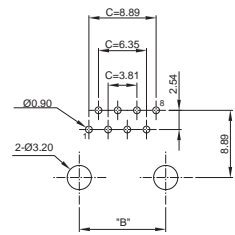
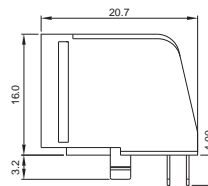
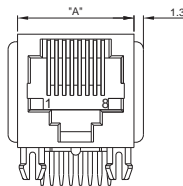
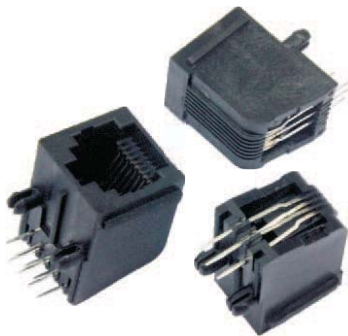

PC Board Layout  
Component Side Shown

Part Number	TYPE	DIM	"A±0.2"	"B±0.2"	"C"
JU440	4P		11.2	7.62	3.81
JU660	6P		13.2	10.16	6.35
JU880	8P		15.3	11.43	8.89

### Side Entry 10P PCB Jack STP

JS80T6

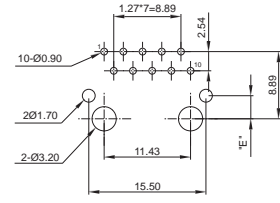
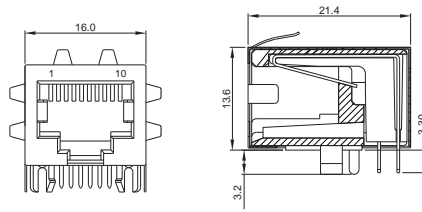
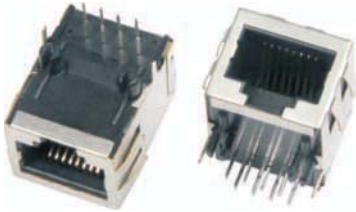

PC Board Layout  
Component Side Shown

### Side Entry 6P PCB Jack UTP

JU66

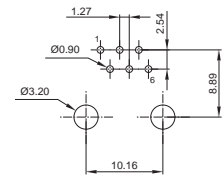
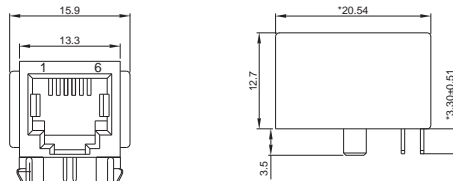

PC Board Layout  
Component Side Shown

### Side Entry 2\*1 8P PCB Doublestack STP

JS8811PFT6

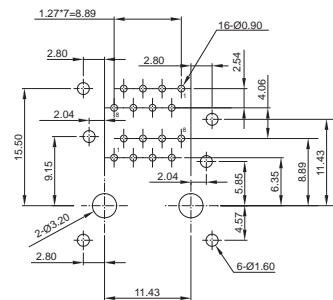
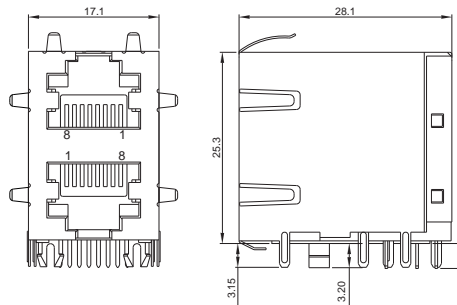
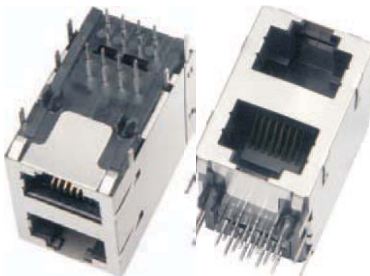

PC Board Layout  
Component Side Shown

**Side Entry 1\*N 8P PCB Jack STP**

JS880NPFT6

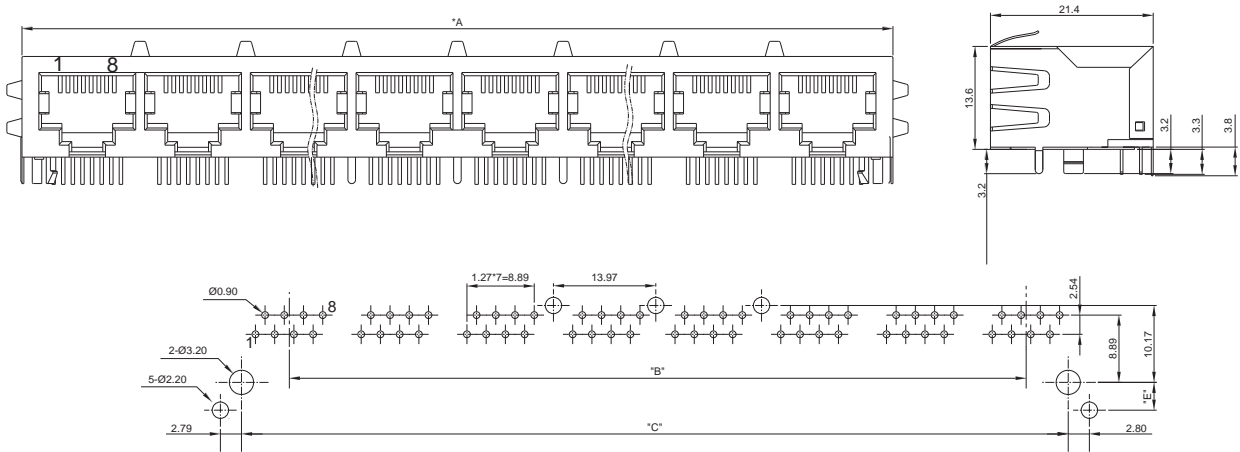
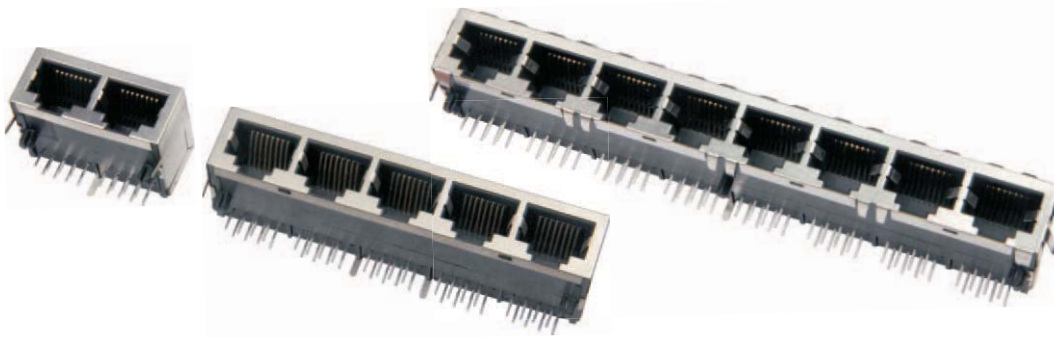

PC Board Layout  
Component Side Shown

Part Number	DIM		"A±0.2"	"B±0.2"	"C"
	TYPE				
JS8801PFT6	1X1		16.00		11.43
JS8802PFT6	1X2		31.24	13.97	25.40
JS8803PFT6	1X3		45.21	27.94	39.37
JS8804PFT6	1X4		59.18	41.91	53.34
JS8805PFT6	1X5		73.15	55.88	67.32
JS8806PFT6	1X6		87.12	69.85	81.28
JS8808PFT6	1X8		115.06	97.79	109.22

### Side Entry 1\*N 8P PCB Jack UTP

JU800N

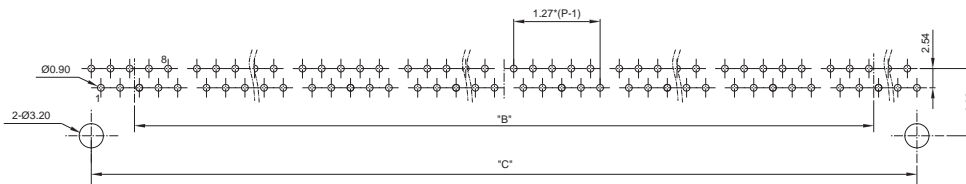
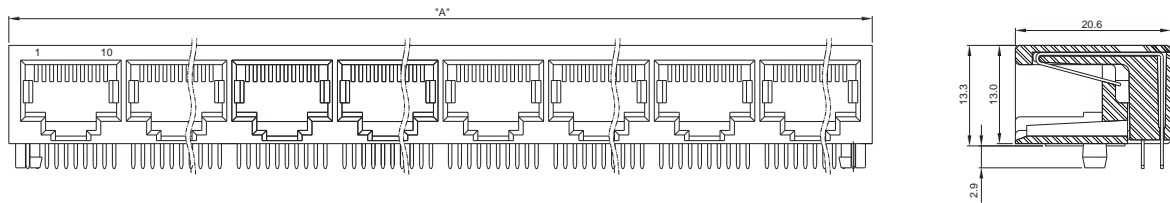
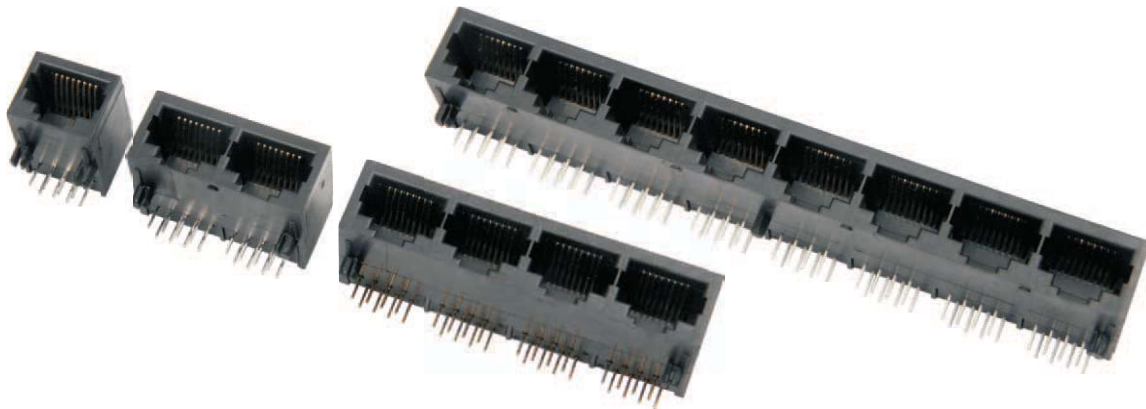

PC Board Layout  
Component Side Shown

Part Number	TYPE	DIM	"A±0.2"	"B±0.2"	"C"
JU8001	1X1		15.20		11.43
JU8002	1X2		30.48	13.97	25.40
JU8003	1X3		44.45	27.94	39.37
JU8004	1X4		58.42	41.91	53.34
JU8005	1X5		73.15	55.88	67.32
JU8006	1X6		86.36	69.85	81.28
JU8008	1X8		114.30	97.79	109.22

Side Entry 2\*N 8P PCB Doublestack UTP

JU881N

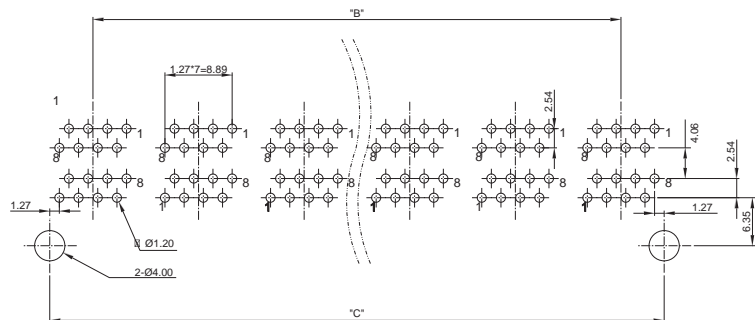
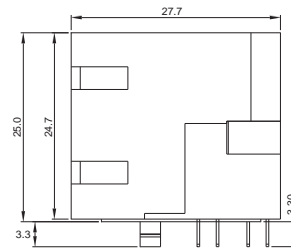
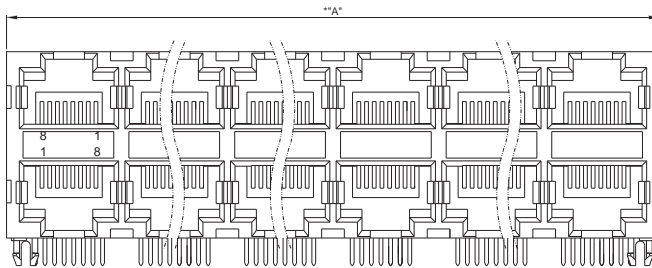
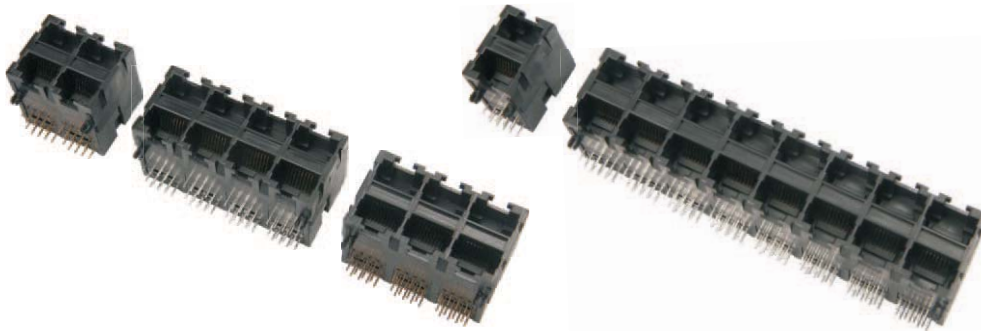

PC Board Layout  
Component Side Shown

Part Number	TYPE	DIM	"A±0.2"	"B±0.2"	"C"
JU8811	2X1		16.50		11.43
JU8812	2X2		30.48	13.97	25.40
JU8813	2X3		44.45	27.94	39.37
JU8814	2X4		58.42	41.91	53.34
JU8815	2X5		72.39	55.88	67.35
JU8816	2X6		86.36	69.85	81.28
JU8818	2X8		114.30	97.79	109.22



**Side Entry 2\*N 8P PCB Jack STP (Stamp)**

JS881NPFT6

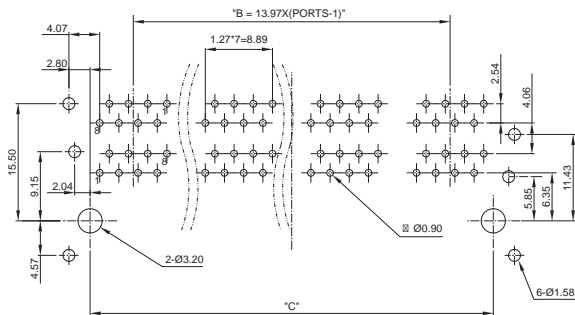
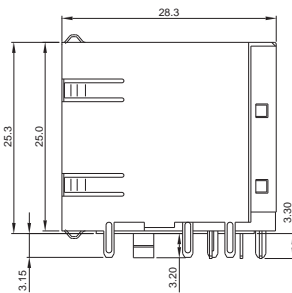
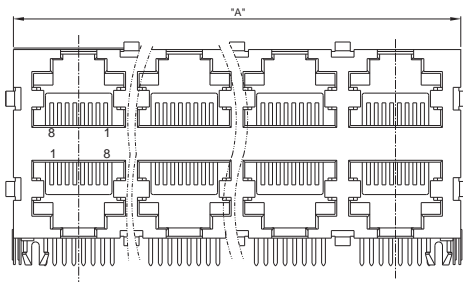
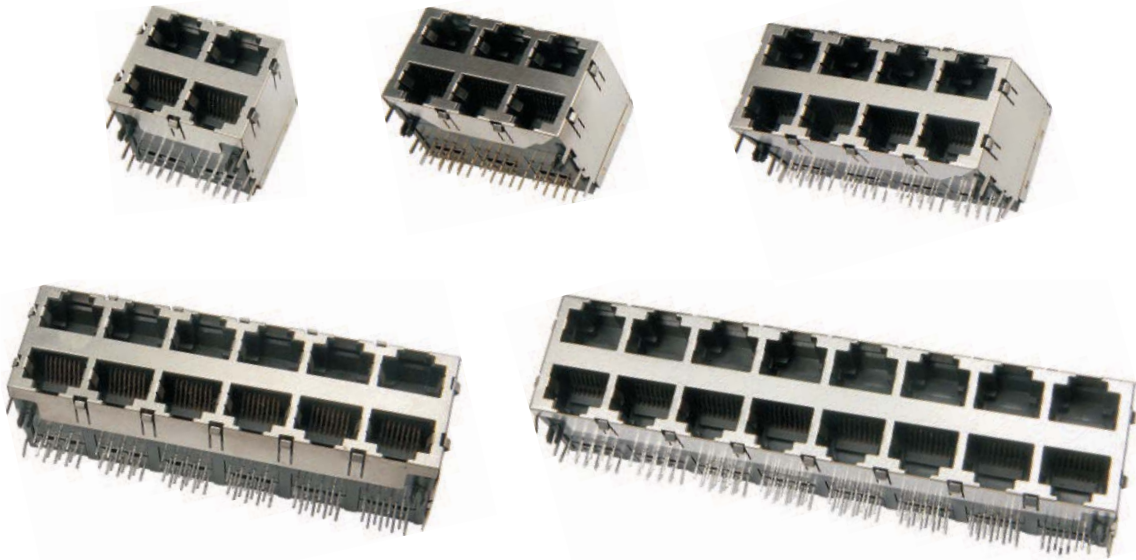

PC Board Layout  
Component Side Shown

Part Number	TYPE	DIM		
		"A±0.2"	"B±0.2"	"C"
JS8812PFT6	2X2	31.24	13.97	25.40
JS8814PFT6	2X4	59.18	41.91	53.34
JS8815PFT6	2X5	73.15	55.88	67.35
JS8816PFT6	2X6	87.12	69.85	81.28
JS8818PFT6	2X8	115.06	97.79	109.22

**Side Entry 6P PCB Jack UTP**

JU66LU

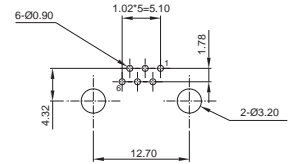
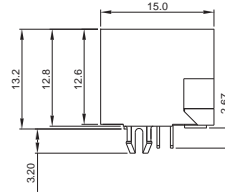
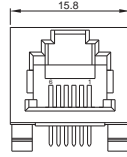

PC Board Layout  
Component Side Shown

**Side Entry 8P PCB Jack Card Edge STP**

JS88LUEDGE

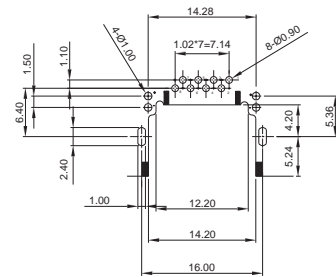
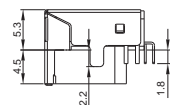
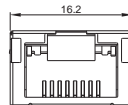

PC Board Layout  
Component Side Shown

**Side Entry 8P SMT PCB Jack STP**

JS88LUSMTT6

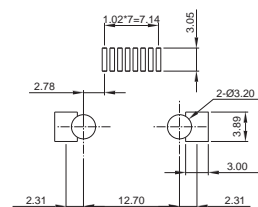
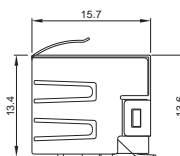
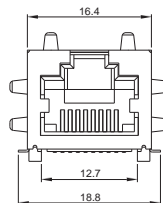

PC Board Layout  
Component Side Shown

### Side Entry L/P 8P LED Jack STP

JS88LLLUT6

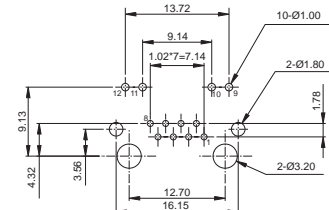
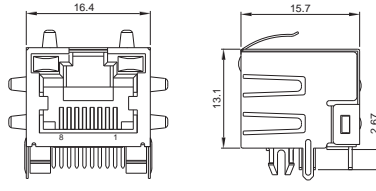

PC Board Layout  
Component Side Shown

### Side Entry 8P LED Jack UTP

JU88LLLUSB

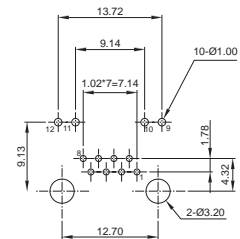
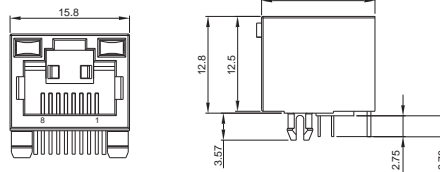

PC Board Layout  
Component Side Shown

### Side Entry L/P 8P LED Jack STP

JS88LLLULP

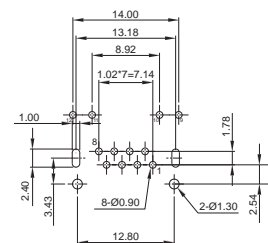
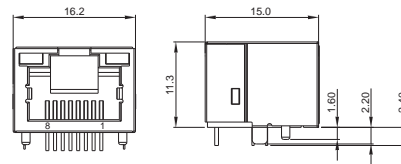

PC Board Layout  
Component Side Shown

**Top Entry 8P LED Jack UTP**

JU88LLV

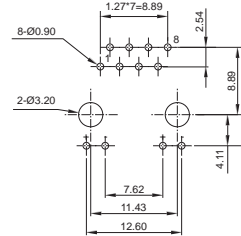
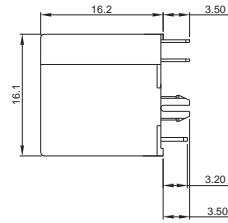
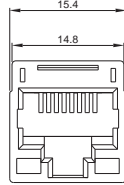

PC Board Layout  
Component Side Shown

**Side Entry 8P LED Jack UTP**

JU88LL

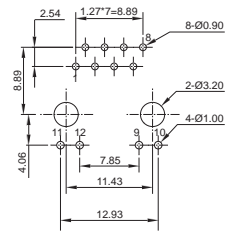
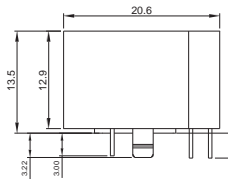
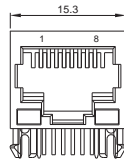
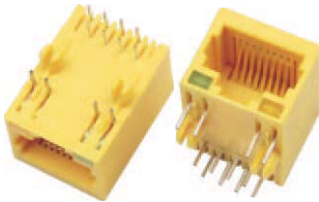

PC Board Layout  
Component Side Shown

**Top Entry L/P 8P LED Jack UTP**

JU88LLVLP

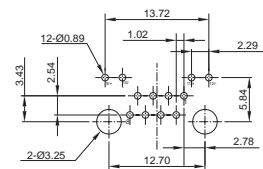
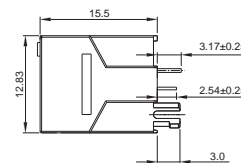
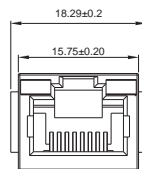

PC Board Layout  
Component Side Shown

### Top Entry 8P LED Jack STP

JS88LLV

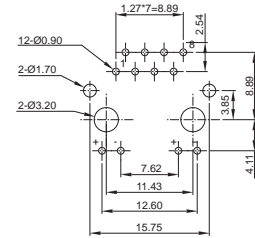
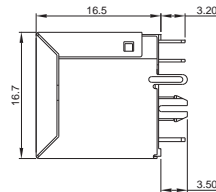
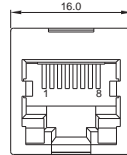

PC Board Layout  
Component Side Shown

### Top Entry L/P 8P LED Jack STP

JS88LLVLP

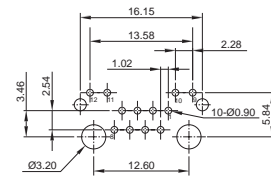
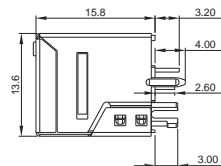
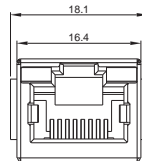

PC Board Layout  
Component Side Shown

**Side Entry 8P LED Jack STP**

JS88LLT6

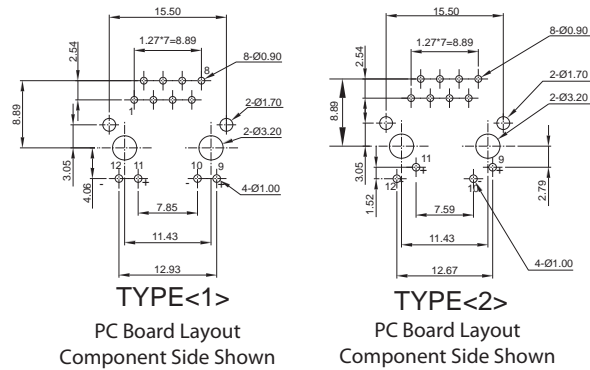
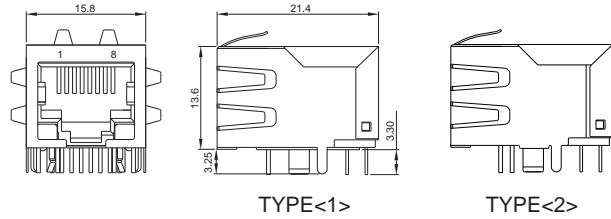
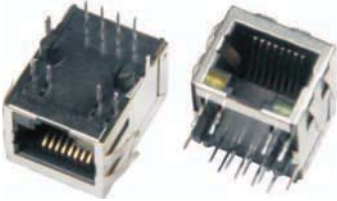

**Side Entry 8P LED Jack STP**

JS88LLPF

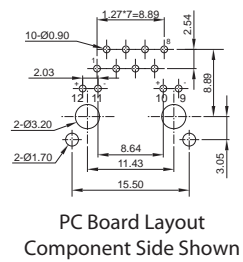
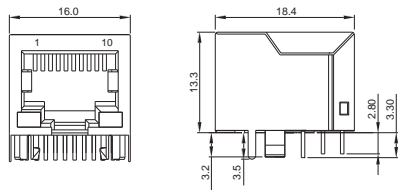

**Side Entry 1\*2 8P LED Jack UTP**

JU8802LL

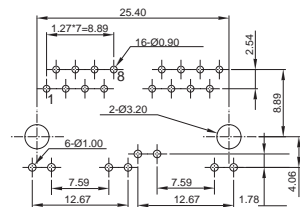
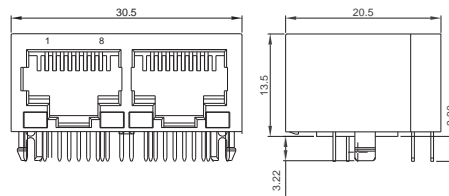

### Side Entry 1\*1, 1\*2, 1\*4 8P PCB Jack UTP

JU880NLU

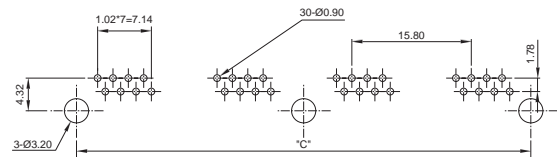
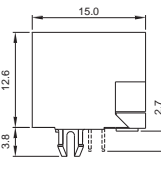
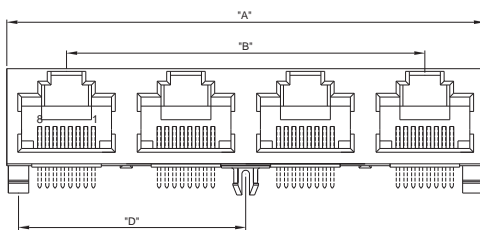

PC Board Layout  
Component Side Shown

Part Number	TYPE	DIM	DIM			
			"A±0.2"	"B±0.2"	"C"	"D"
JU8801LU	1X1		15.80		12.70	
JU8802LU	1X2		31.60	15.80	28.50	
JU8804LU	1X4		63.20	47.40	60.10	30.10

### Side Entry 1\*1, 1\*2, 1\*4 8P LED Jack UTP

JU880NLLLU

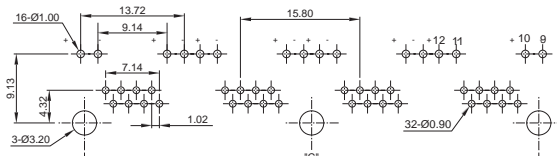
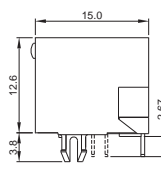
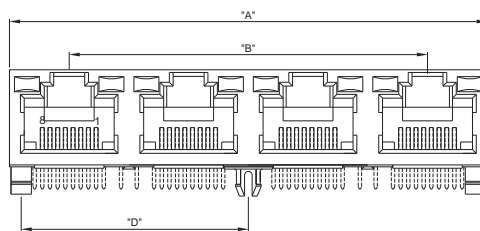
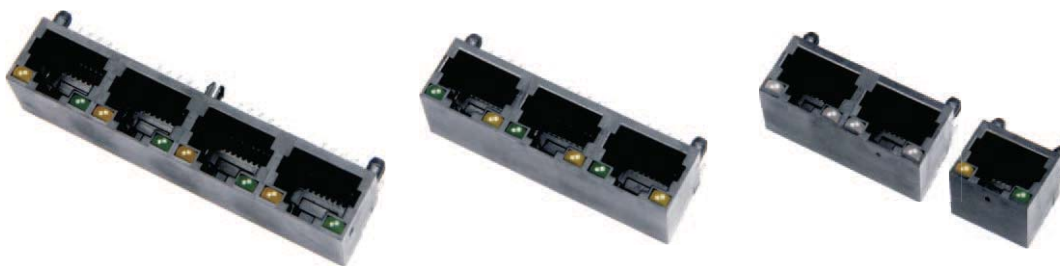

PC Board Layout  
Component Side Shown

Part Number	TYPE	DIM	DIM			
			"A±0.2"	"B±0.2"	"C"	"D"
JU8801LLLU	1X1		15.80		12.70	
JU8802LLLU	1X2		31.60	15.80	28.50	
JU8804LLLU	1X4		47.40	31.60	44.30	

**Side Entry 1\*4 8P PCB Jack Card Edge STP**

JS8804EDGET6

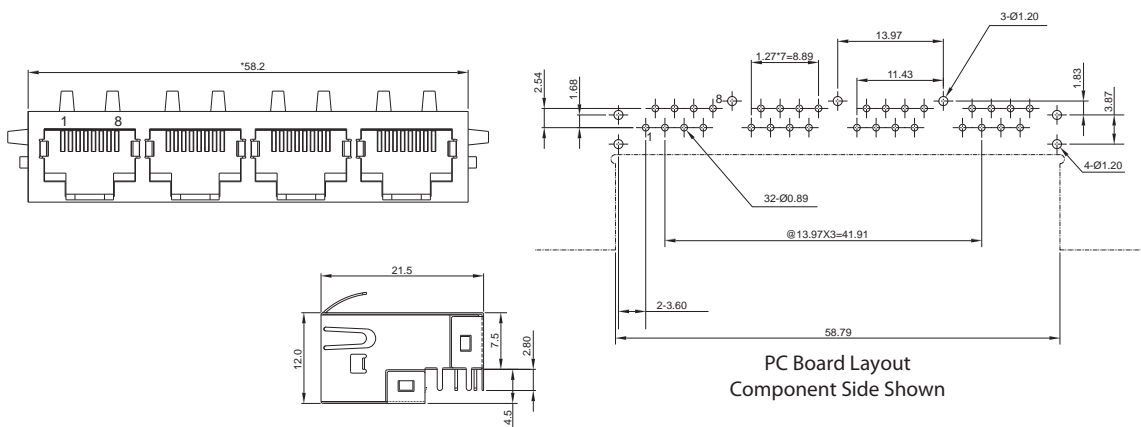
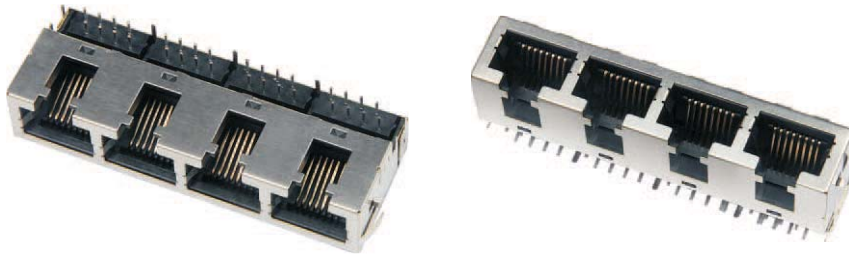

**Top Entry 1\*4 8P LED Jack STP**

JS8804LLV

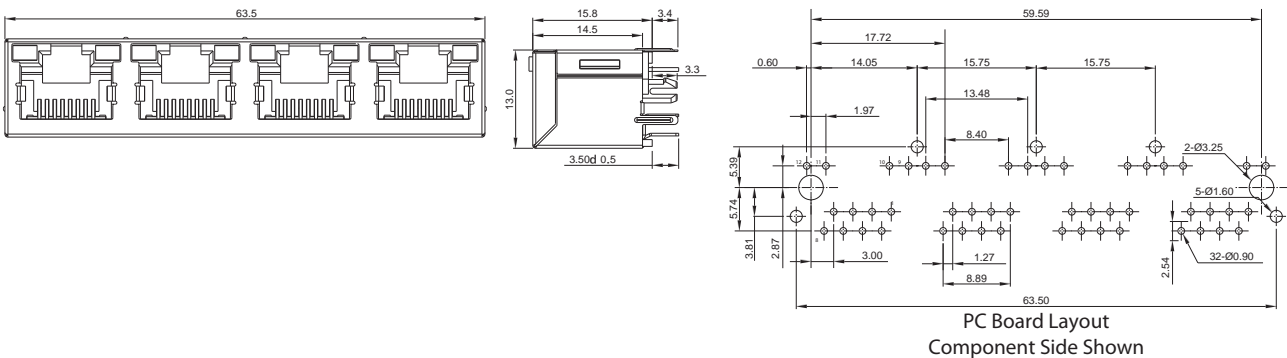



### Side Entry 1\*2, 1\*4 8P LED Jack STP

JS880NLLT6

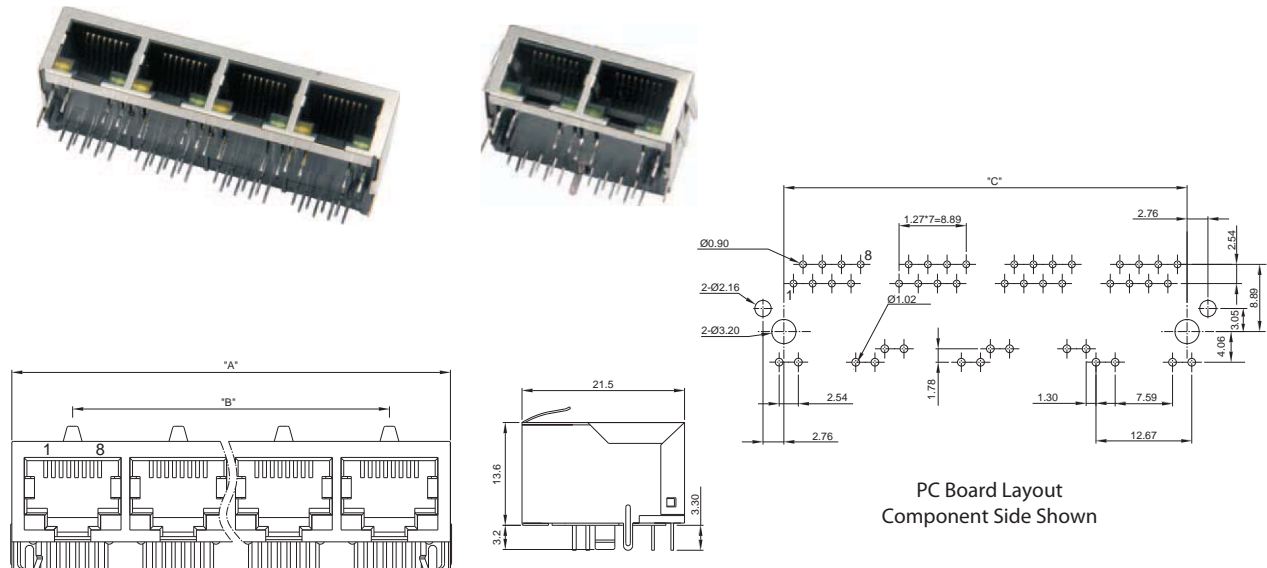

Part Number	TYPE	DIM	"A±0.2"	"B±0.2"	"C±0.2"
JS8802LLT6	1X2		31.24	13.97	25.40
JS8804LLT6	1X4		59.18	41.91	53.34

### Side Entry 1\*4 8P LED Jack UTP

JU8804LL

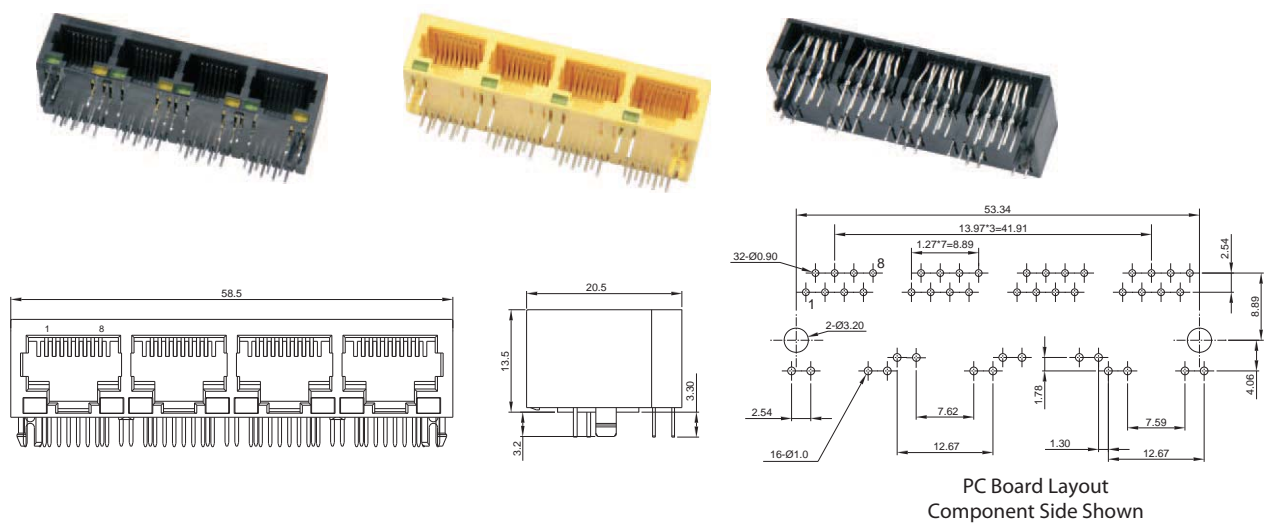

Side Entry 1\*N 8P LED Jack STP

JS880NLLLUT6

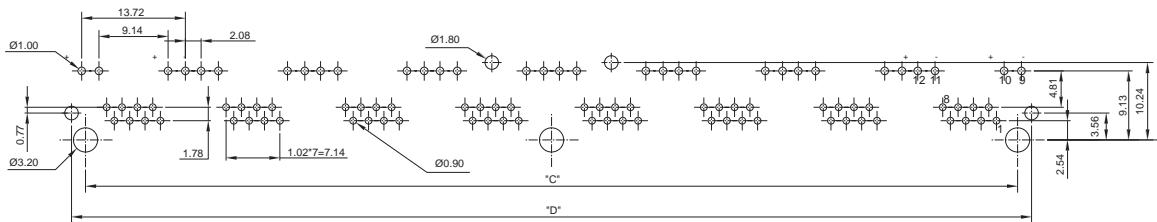
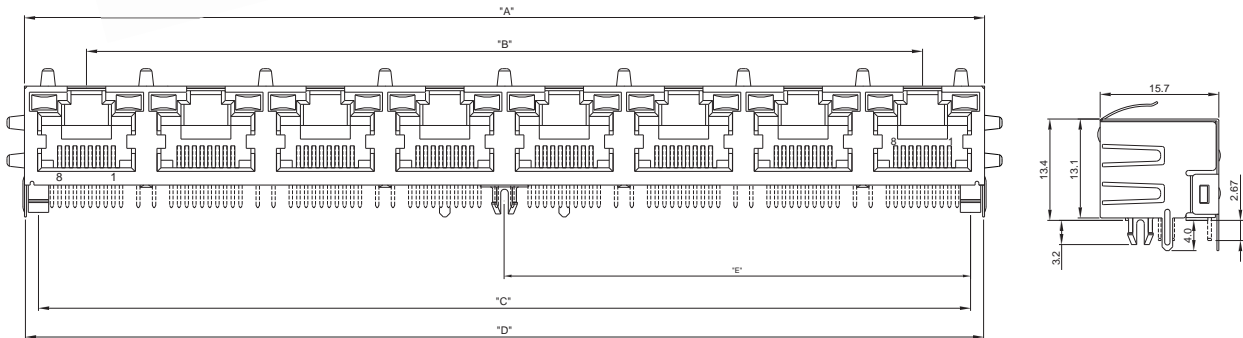

PC Board Layout  
Component Side Shown

LED Part Number	TYPE	DIM	"A±0.2"	"B±0.2"	"C"	"D"	"E"
JS8801LLLUT6	1X1		16.40		12.70	16.16	
JS8802LLLUT6	1X2		32.20	15.80	28.50	31.95	
JS8803LLLUT6	1X3		48.00	31.60	44.30	47.75	
JS8804LLLUT6	1X4		63.80	47.40	60.10	63.55	30.10
JS8808LLLUT6	1X8		127.00	110.60	123.30	127.00	61.65

**45 8P RJ45 Jack STP**

JS88AQ

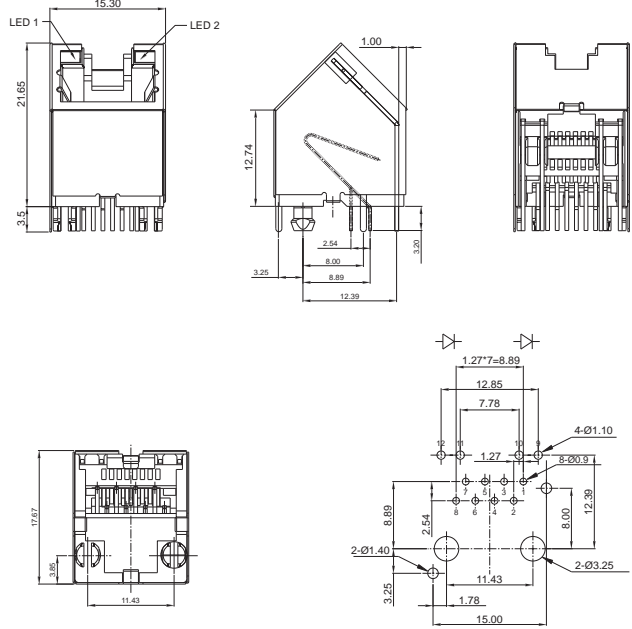
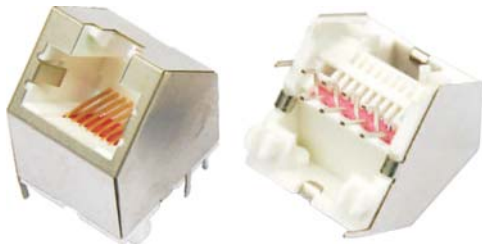

PC Board Layout  
Component Side Shown

**Side Entry 2\*1 8P LED Doublestack STP**

JS8811LLT6PF

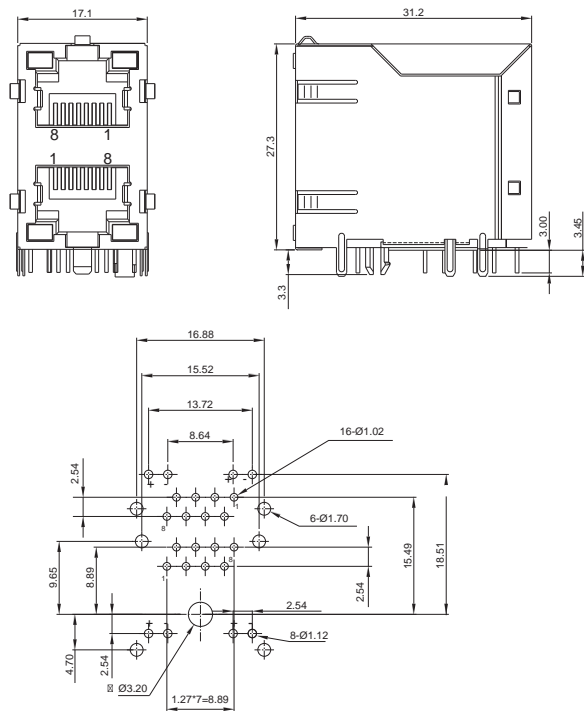
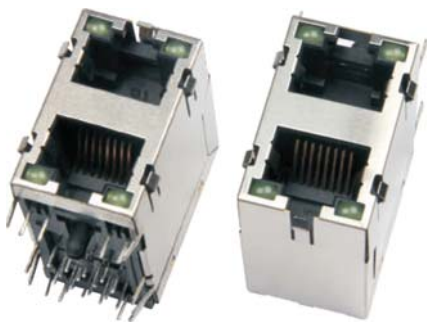

PC Board Layout  
Component Side Shown

Side Entry 2\*N 8P LED Doublestack STP

JS881NLLPFT6

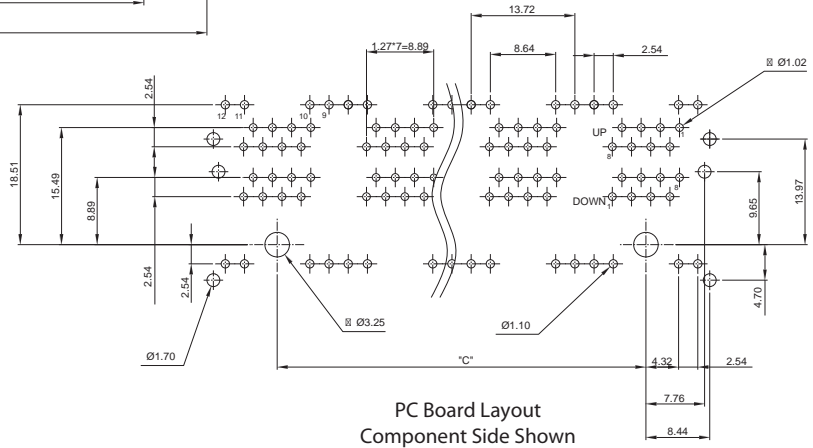
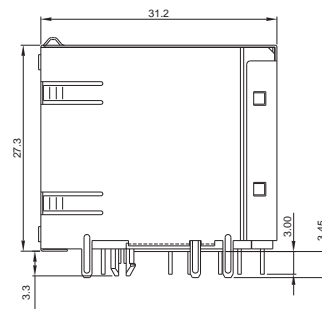
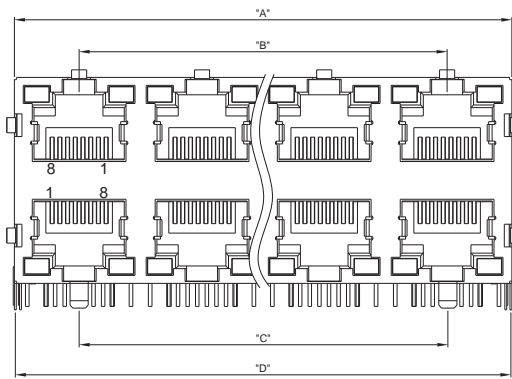
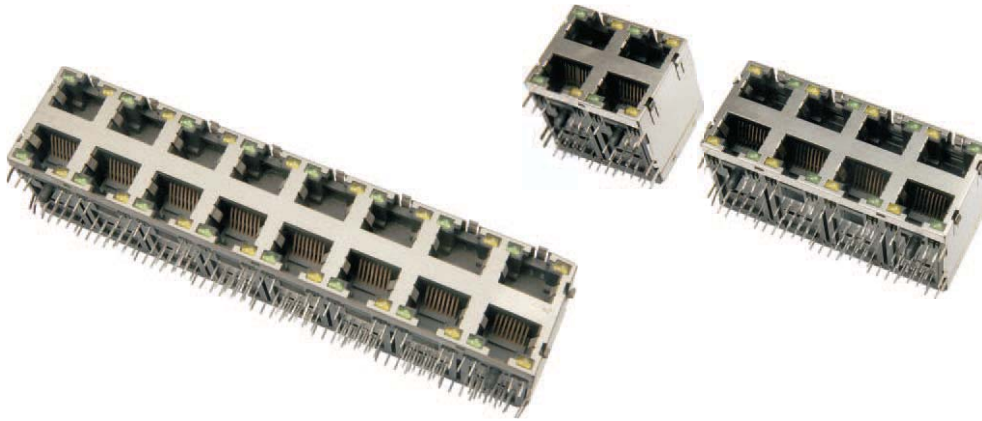

Part Number	DIM		"A±0.2"	"B±0.2"	"C"	"D"
	TYPE					
JS8812LLPFT6	2X2		33.40	16.26	16.26	33.10
JS8813LLPFT6	2X3		49.45	32.52	32.52	49.15
JS8814LLPFT6	2X4		65.90	48.78	48.78	65.60
JS8816LLPFT6	2X6		98.43	81.30	81.30	98.13
JS8818LLPFT6	2X8		130.95	113.82	113.82	130.65

### C5e Side Entry 1\*N 8P PCB Jack STP

JS880NPFE5T6

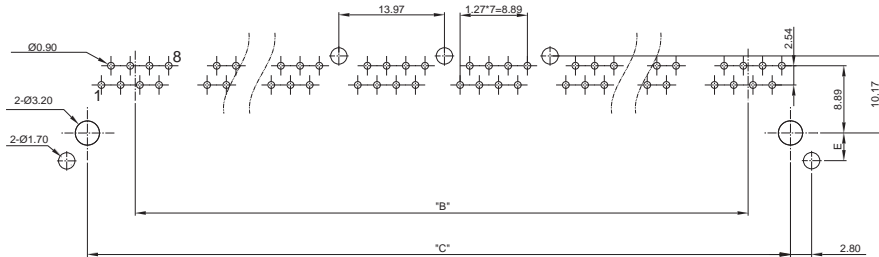
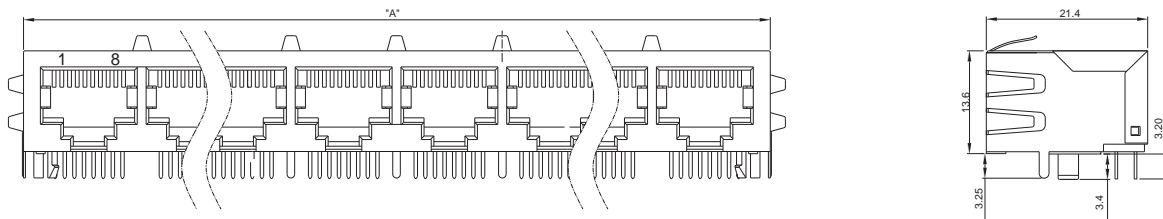
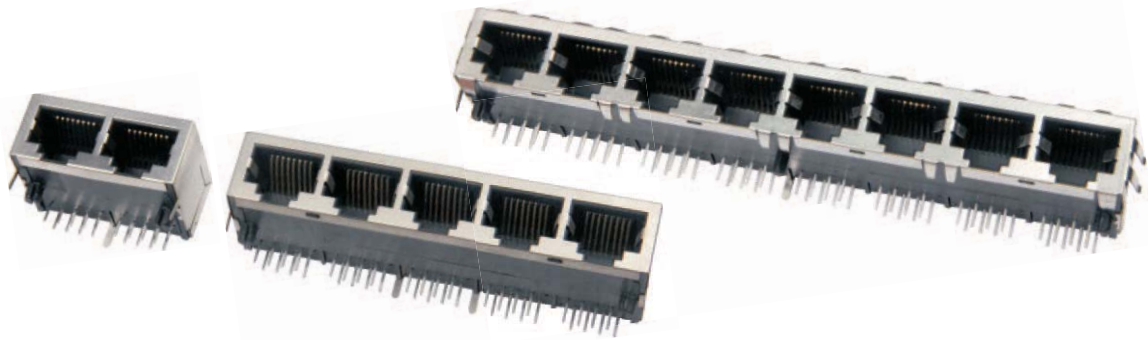

PC Board Layout  
Component Side Shown

Part Number	TYPE	DIM	"A±0.2"	"B±0.2"	"C"
JS8802PFE5T6	1x2		31.24	13.97	25.40
JS8804PFE5T6	1x4		59.18	41.91	53.34
JS8808PFE5T6	1x8		115.06	97.79	109.22

Frequency MHz	Near-End Cross Talk dB, Min.	Return Loss dB, Min.	Attenuation dB, Max.
1.0	65	30	0.1
4.0	65	30	0.1
8.0	64.9	30	0.1
10.0	63	30	0.1
16.0	58.9	30	0.2
20.0	57	30	0.2
25.0	55	30	0.2
31.25	53.1	30	0.2
62.5	47.1	24.1	0.3
100.0	43	20	0.4

**C5e Side Entry 8P LED Jack STP**

JS88LLE5T6

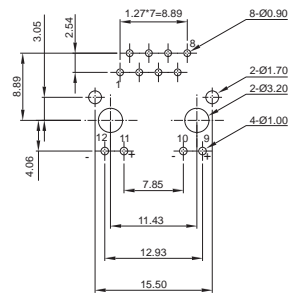
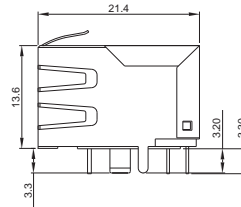
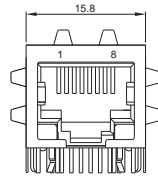
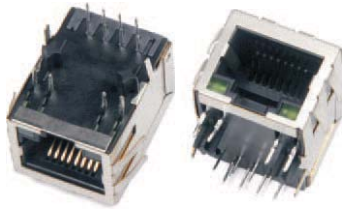

PC Board Layout  
Component Side Shown

Frequency MHz	Near-End Cross Talk dB, Min.	Return Loss dB, Min.	Attenuation dB, Max.
1.0	65	30	0.1
4.0	65	30	0.1
8.0	64.9	30	0.1
10.0	63	30	0.1
16.0	58.9	30	0.2
20.0	57	30	0.2
25.0	55	30	0.2
31.25	53.1	30	0.2
62.5	47.1	24.1	0.3
100.0	43	20	0.4

**C5e Side Entry 8P PCB Jack STP**

JS88E5T6

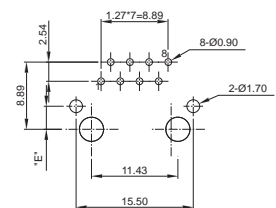
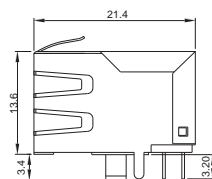
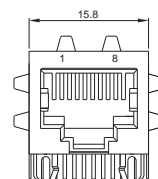
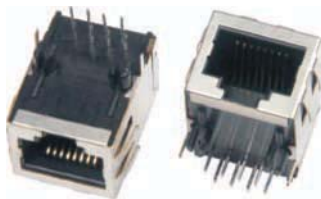

PC Board Layout  
Component Side Shown

Frequency MHz	Near-End Cross Talk dB, Min.	Return Loss dB, Min.	Attenuation dB, Max.
1.0	65	30	0.1
4.0	65	30	0.1
8.0	64.9	30	0.1
10.0	63	30	0.1
16.0	58.9	30	0.2
20.0	57	30	0.2
25.0	55	30	0.2
31.25	53.1	30	0.2
62.5	47.1	24.1	0.3
100.0	43	20	0.4

### C5e Side Entry 1\*N 8P PCB Jack UTP

JU800NE5

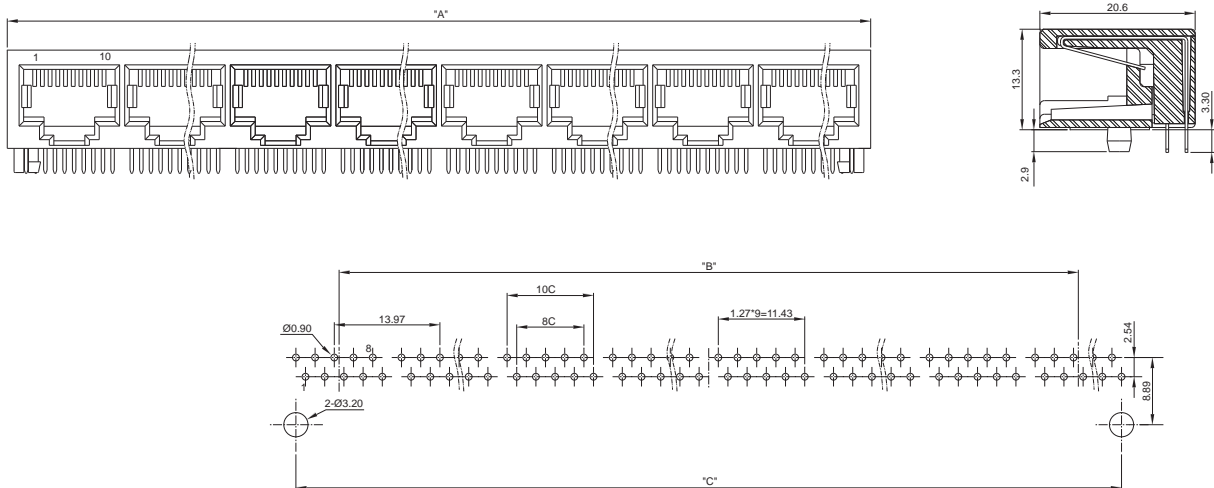
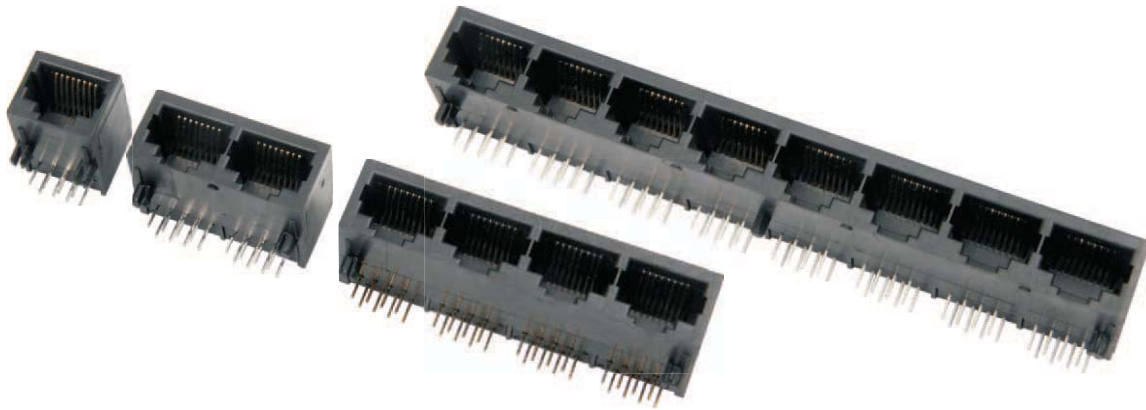

PC Board Layout  
Component Side Shown

Part Number	TYPE DIM	"A±0.2"	"B±0.2"	"C"
JU8001E5	1X1	15.20		11.43
JU8002E5	1X2	30.48	13.97	25.40
JU8003E5	1X3	44.45	27.94	39.37
JU8004E5	1X4	58.42	41.91	53.34
JU8005E5	1X5	73.15	55.88	67.32
JU8006E5	1X6	86.36	69.85	81.28
JU8008E5	1X8	114.30	97.79	109.22

Frequency MHz	Near-End Cross Talk dB, Min.	Return Loss dB, Min.	Attenuation dB, Max.
1.0	65	30	0.1
4.0	65	30	0.1
8.0	64.9	30	0.1
10.0	63	30	0.1
16.0	58.9	30	0.2
20.0	57	30	0.2
25.0	55	30	0.2
31.25	53.1	30	0.2
62.5	47.1	24.1	0.3
100.0	43	20	0.4

**C5e Side Entry 2\*1 8P PCB Doublestack STP**

JS8811PFE5T6

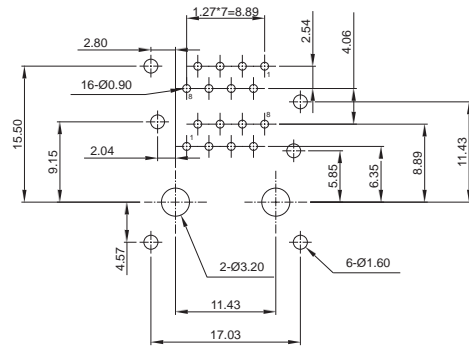
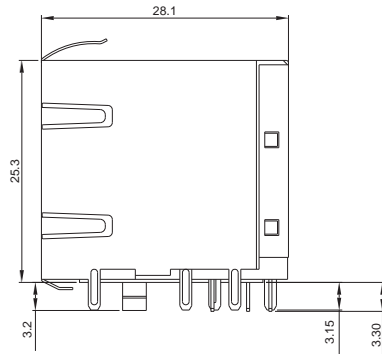
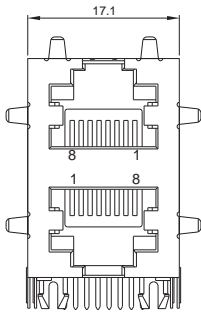
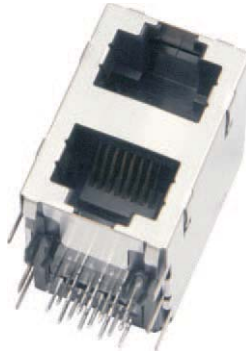

PC Board Layout  
Component Side Shown

Frequency MHz	Near-End Cross Talk dB, Min.	Return Loss dB, Min.	Attenuation dB, Max.
1.0	65	30	0.1
4.0	65	30	0.1
8.0	64.9	30	0.1
10.0	63	30	0.1
16.0	58.9	30	0.2
20.0	57	30	0.2
25.0	55	30	0.2
31.25	53.1	30	0.2
62.5	47.1	24.1	0.3
100.0	43	20	0.4



### C5e Side Entry 2\*N 8P PCB Doublestack STP

JS881NPF5T6

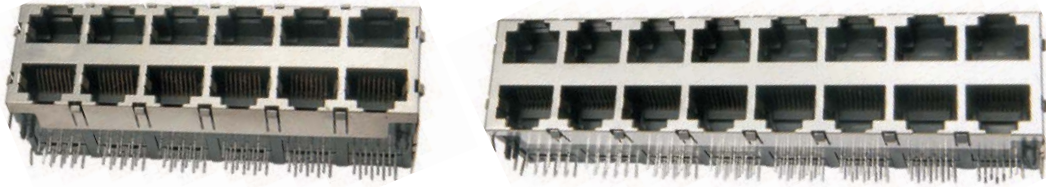

JU881NPF5

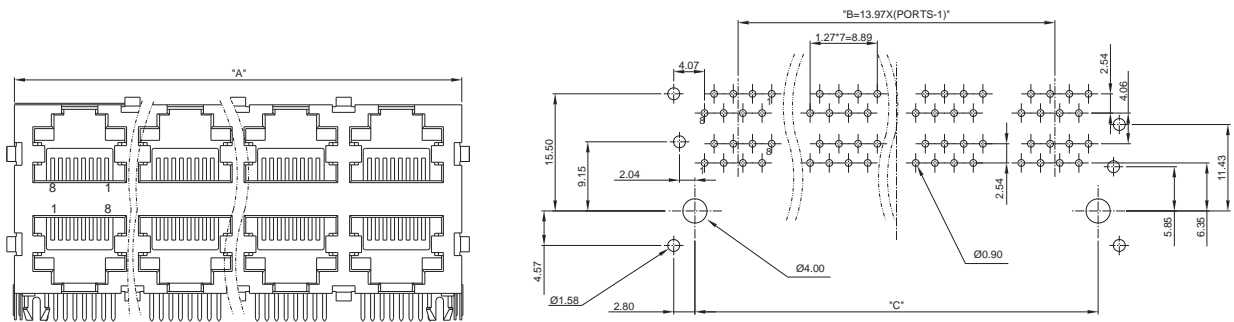
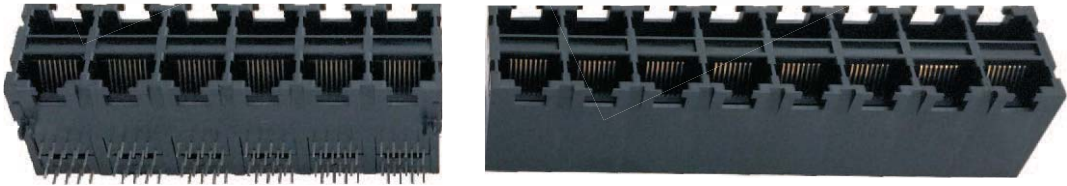

PC Board Layout  
Component Side Shown

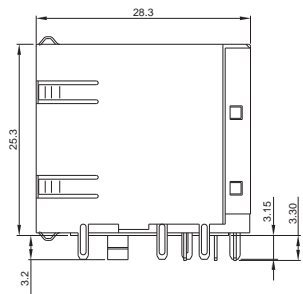

Part Number	TYPE	DIM	"A±0.2"	"B±0.2"	"C"
JS8812...	2X2		31.24	13.97	25.40
JS8814....	2X4		59.18	41.91	53.34
JS8815...	2X5		73.15	55.88	67.35
JS8816...	2X6		87.12	69.85	81.28
JS8818...	2X8		115.06	97.79	109.22

Frequency MHz	Near-End Cross Talk dB, Min.	Return Loss dB, Min.	Attenuation dB, Max.
1.0	65	30	0.1
4.0	65	30	0.1
8.0	64.9	30	0.1
10.0	63	30	0.1
16.0	58.9	30	0.2
20.0	57	30	0.2
25.0	55	30	0.2
31.25	53.1	30	0.2
62.5	47.1	24.1	0.3
100.0	43	20	0.4

**C5e Side Entry 1\*N 8P LED Jack STP**

JS880NLE5T6

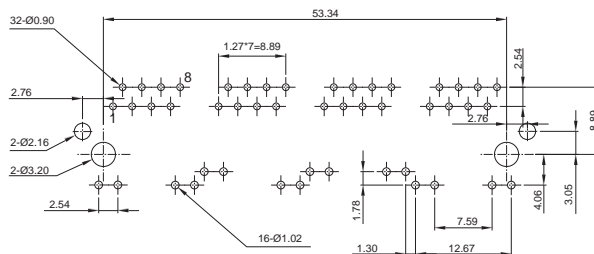
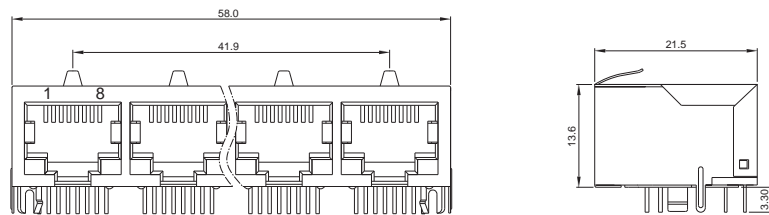
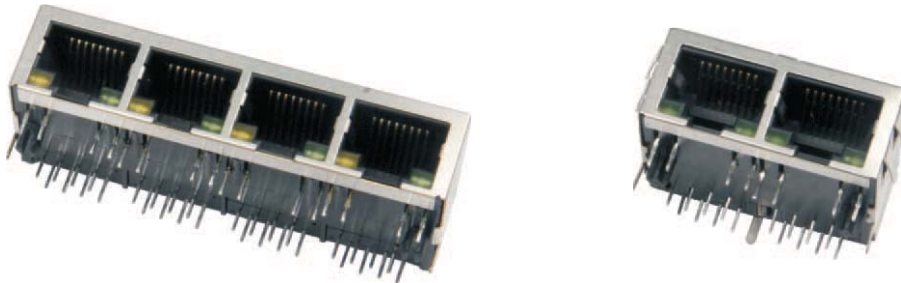

PC Board Layout  
Component Side Shown

Frequency MHz	Near-End Cross Talk dB, Min.	Return Loss dB, Min.	Attenuation dB, Max.
1.0	65	30	0.1
4.0	65	30	0.1
8.0	64.9	30	0.1
10.0	63	30	0.1
16.0	58.9	30	0.2
20.0	57	30	0.2
25.0	55	30	0.2
31.25	53.1	30	0.2
62.5	47.1	24.1	0.3
100.0	43	20	0.4

### C5e Side Entry 2\*N 8P LED Doublestack STP

JS881NLLPFE5T6

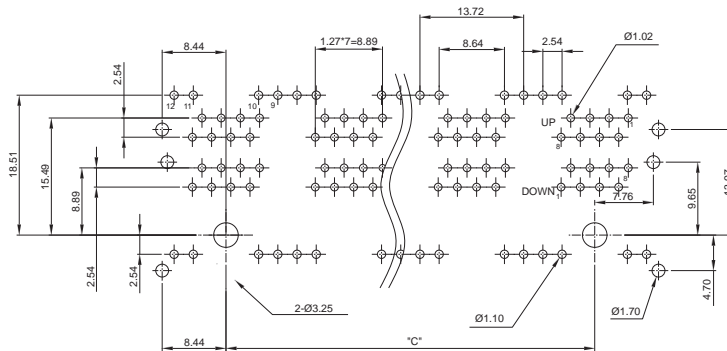
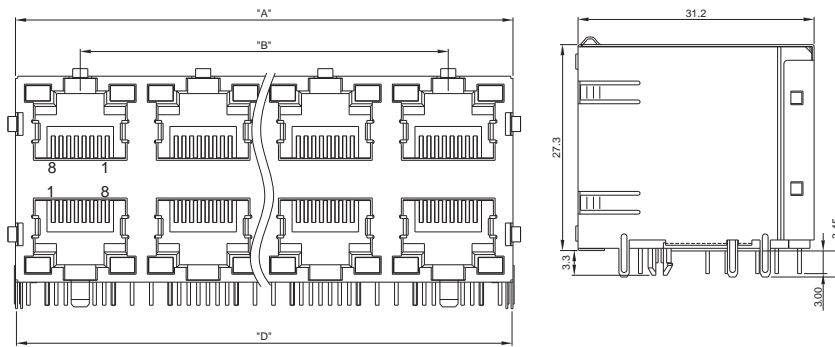
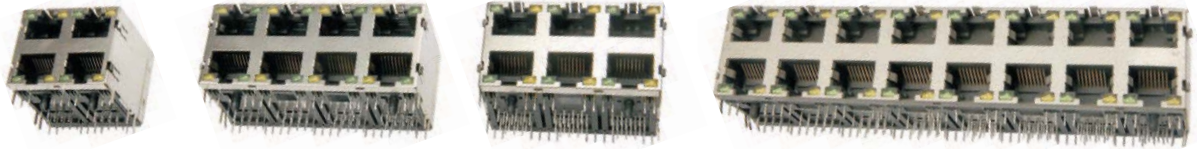

PC Board Layout  
Component Side Shown

Frequency MHz	Near-End Cross Talk dB, Min.	Return Loss dB, Min.	Attenuation dB, Max.
1.0	65	30	0.1
4.0	65	30	0.1
8.0	64.9	30	0.1
10.0	63	30	0.1
16.0	58.9	30	0.2
20.0	57	30	0.2
25.0	55	30	0.2
31.25	53.1	30	0.2
62.5	47.1	24.1	0.3
100.0	43	20	0.4

Part Number	TYPE DIM	"A±0.2"	"B±0.2"	"C"	"D"
JS8811LLPFE5T6	2X1	17.10			16.88
JS8812LLPFE5T6	2X2	33.40	16.26	16.26	33.10
JS8813LLPFE5T6	2X3	49.45	32.52	32.52	49.15
JS8814LLPFE5T6	2X4	65.90	48.78	48.78	65.60
JS8816LLPFE5T6	2X6	98.43	81.30	81.30	98.13
JS8818LLPFE5T6	2X8	130.95	113.82	113.82	130.65

**C6 Side Entry PCB Jack UTP**

JU88C6LU

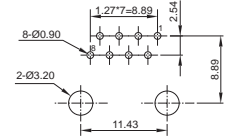
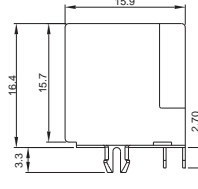
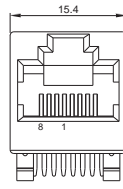

PC Board Layout  
Component Side Shown

Frequency MHz	Near-End Cross Talk dB, Min.	Return Loss dB, Min.	Attenuation dB, Max.
1.0	75.0	35.5	0.1
4.0	75.0	35.5	0.1
10.0	74.0	35.5	0.1
16.0	69.9	35.5	0.1
25.0	66.0	35.5	0.1
31.25	64.1	34.1	0.1
62.5	58.1	28.1	0.1
100.0	54.0	24.0	0.2
200.0	48.0	18.0	0.3
250.0	46.0	16.0	0.3

**C6 Top Entry PCB Jack UTP**

JU88VC6

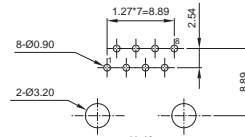
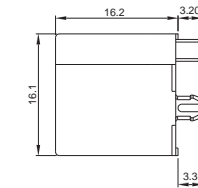
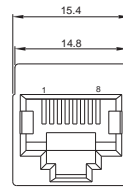

PC Board Layout  
Component Side Shown

Frequency MHz	Near-End Cross Talk dB, Min.	Return Loss dB, Min.	Attenuation dB, Max.
1.0	75.0	35.5	0.1
4.0	75.0	35.5	0.1
10.0	74.0	35.5	0.1
16.0	69.9	35.5	0.1
25.0	66.0	35.5	0.1
31.25	64.1	34.1	0.1
62.5	58.1	28.1	0.1
100.0	54.0	24.0	0.2
200.0	48.0	18.0	0.3
250.0	46.0	16.0	0.3

**C6 Top Entry 8P+2P Switch PCB Jack UTP**

JU88VC6SW

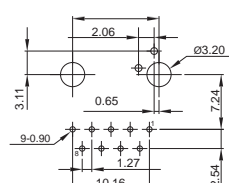
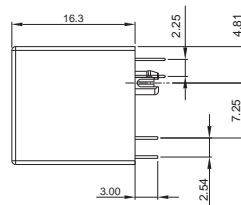
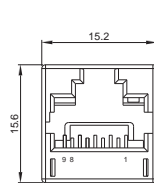

PC Board Layout  
Component Side Shown

Frequency MHz	Near-End Cross Talk dB, Min.	Return Loss dB, Min.	Attenuation dB, Max.
1.0	75.0	35.5	0.1
4.0	75.0	35.5	0.1
10.0	74.0	35.5	0.1
16.0	69.9	35.5	0.1
25.0	66.0	35.5	0.1
31.25	64.1	34.1	0.1
62.5	58.1	28.1	0.1
100.0	54.0	24.0	0.2
200.0	48.0	18.0	0.3
250.0	46.0	16.0	0.3

### C6 47.5 8 P RB Jack TP

JU88C6A

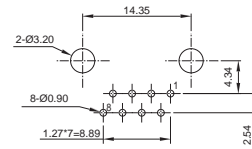
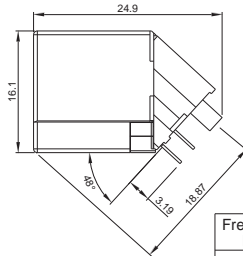
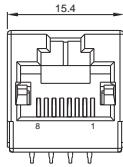

PC Board Layout  
Component Side Shown

Frequency MHz	Near-End Cross Talk dB, Min.	Return Loss dB, Min.	Attenuation dB, Max.
1.0	75.0	35.5	0.1
4.0	75.0	35.5	0.1
10.0	74.0	35.5	0.1
16.0	69.9	35.5	0.1
25.0	66.0	35.5	0.1
31.25	64.1	34.1	0.1
62.5	58.1	28.1	0.1
100.0	54.0	24.0	0.2
200.0	48.0	18.0	0.3
250.0	46.0	16.0	0.3

### C6 Side Entry 8P PCB Jack STP

JS88C6LU

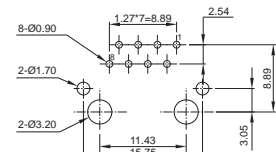
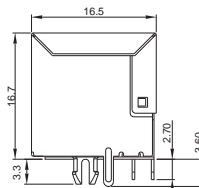
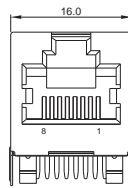
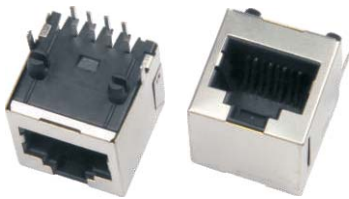

PC Board Layout  
Component Side Shown

Frequency MHz	Near-End Cross Talk dB, Min.	Return Loss dB, Min.	Attenuation dB, Max.
1.0	75.0	35.5	0.1
4.0	75.0	35.5	0.1
10.0	74.0	35.5	0.1
16.0	69.9	35.5	0.1
25.0	66.0	35.5	0.1
31.25	64.1	34.1	0.1
62.5	58.1	28.1	0.1
100.0	54.0	24.0	0.2
200.0	48.0	18.0	0.3
250.0	46.0	16.0	0.3

### C6 Top Entry 8P PCB Jack STP

JS88VC6

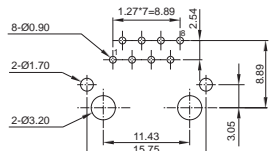
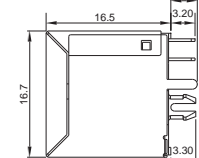
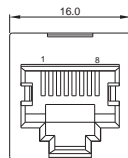

PC Board Layout  
Component Side Shown

Frequency MHz	Near-End Cross Talk dB, Min.	Return Loss dB, Min.	Attenuation dB, Max.
1.0	75.0	35.5	0.1
4.0	75.0	35.5	0.1
10.0	74.0	35.5	0.1
16.0	69.9	35.5	0.1
25.0	66.0	35.5	0.1
31.25	64.1	34.1	0.1
62.5	58.1	28.1	0.1
100.0	54.0	24.0	0.2
200.0	48.0	18.0	0.3
250.0	46.0	16.0	0.3

**C6 47.5 PCB Jack STP**

JS88C6A

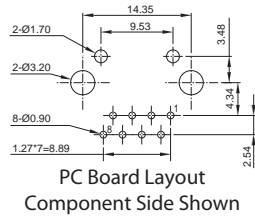
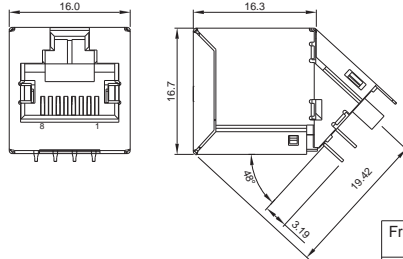

Frequency MHz	Near-End Cross Talk dB, Min.	Return Loss dB, Min.	Attenuation dB, Max.
1.0	75.0	35.5	0.1
4.0	75.0	35.5	0.1
10.0	74.0	35.5	0.1
16.0	69.9	35.5	0.1
25.0	66.0	35.5	0.1
31.25	64.1	34.1	0.1
62.5	58.1	28.1	0.1
100.0	54.0	24.0	0.2
200.0	48.0	18.0	0.3
250.0	46.0	16.0	0.3

**C6 Top Entry 8P PCB Jack STP**

JS88VC6PF

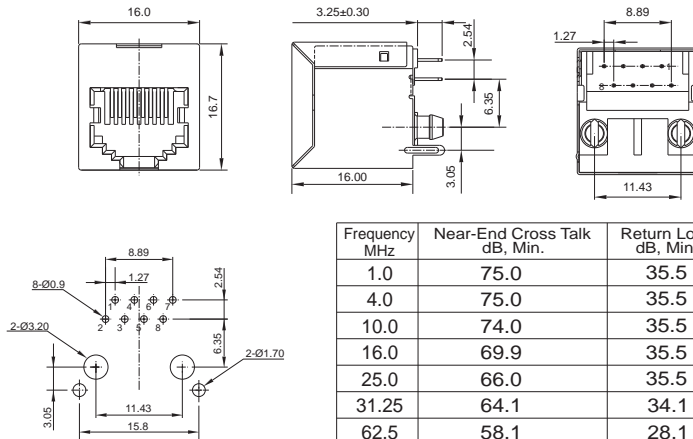
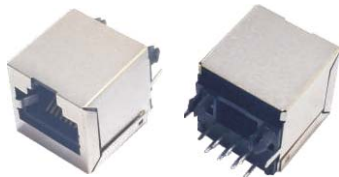

PC Board Layout  
Component Side Shown

Frequency MHz	Near-End Cross Talk dB, Min.	Return Loss dB, Min.	Attenuation dB, Max.
1.0	75.0	35.5	0.1
4.0	75.0	35.5	0.1
10.0	74.0	35.5	0.1
16.0	69.9	35.5	0.1
25.0	66.0	35.5	0.1
31.25	64.1	34.1	0.1
62.5	58.1	28.1	0.1
100.0	54.0	24.0	0.2
200.0	48.0	18.0	0.3
250.0	46.0	16.0	0.3

**C5e Top Entry 8P PCB Jack Press Fit STP**

JU88VE5Z

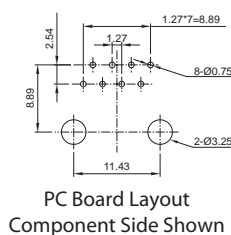
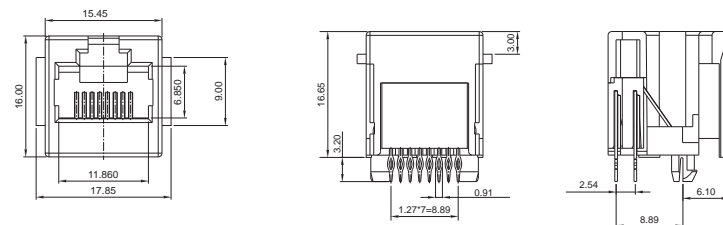

Frequency MHz	Near-End Cross Talk dB, Min.	Return Loss dB, Min.	Attenuation dB, Max.
1.0	65	30	0.1
4.0	65	30	0.1
8.0	64.9	30	0.1
10.0	63	30	0.1
16.0	58.9	30	0.2
20.0	57	30	0.2
25.0	55	30	0.2
31.25	53.1	30	0.2
62.5	47.1	24.1	0.3
100.0	43	20	0.4